

**RESOLUTION NO. 2001-106**

A RESOLUTION OF THE BOARD OF COUNTY COMMISSIONERS OF NASSAU COUNTY, FLORIDA, RELATING TO THE CONSTRUCTION AND FUNDING OF ROAD IMPROVEMENTS; CREATING THE PIRATES WOOD ASSESSMENT AREA; CONFIRMING THE INITIAL ASSESSMENT RESOLUTION; ESTABLISHING THE MAXIMUM AMOUNT OF THE ANNUAL ASSESSMENT FOR EACH PARCEL UNIT; IMPOSING ASSESSMENTS AGAINST PROPERTY WITHIN THE PIRATES WOOD ASSESSMENT AREA; APPROVING THE ASSESSMENT ROLL; PROVIDING FOR COLLECTION OF THE ASSESSMENTS; AND PROVIDING AN EFFECTIVE DATE.

**WHEREAS**, the Board of County Commissioners (the "Board") of Nassau County, Florida, enacted Ordinance No. 2000-37 (the "Ordinance"), to provide for the creation of Assessment Areas (as described thereunder) and authorize the imposition of special assessments to fund the construction of local improvements to serve the property located therein; and

**WHEREAS**, on May 14, 2001, the Board adopted Resolution No. 2001-74, the Initial Assessment Resolution, proposing creation of the Pirates Wood Assessment Area and describing the method of assessing the cost of Road Improvements (as therein defined) against the real property that will be specially benefitted thereby, and directing preparation of the tentative Assessment Roll and provision of the notices required by the Ordinance; and

**WHEREAS**, pursuant to the provisions of the Ordinance, the County is required to confirm or repeal the Initial Assessment Resolution, with such amendments as the Board deems appropriate, after hearing comments and receiving objections of all interested parties; and

**WHEREAS**, the Assessment Roll has heretofore been filed with the office of the County Coordinator, as required by the Initial Assessment Resolution and the Ordinance; and

**WHEREAS**, as required by the terms of the Initial Assessment Resolution and the Ordinance, notice of a public hearing has been published and mailed to each property owner proposed to be assessed notifying such property owner of the opportunity to be heard; the proof of publication and an affidavit of mailing are attached hereto as Appendices A and B respectively; and

**WHEREAS**, in order to allow additional time to obtain more favorable financial terms, on June 18, 2001 the Board continued a hearing to, and on July 16, 2001 a public hearing was held and comments and objections of all interested persons were heard and considered as required by the terms of the Ordinance.

**NOW, THEREFORE, BE IT RESOLVED BY THE BOARD OF COUNTY COMMISSIONERS OF NASSAU COUNTY, FLORIDA, AS FOLLOWS:**

**SECTION 1. AUTHORITY.** This Resolution is adopted pursuant to the Ordinance, Chapter 125, Florida Statutes, and other applicable provisions of law.

**SECTION 2. DEFINITIONS.** This Resolution is the Final Assessment Resolution as defined in the Ordinance. All capitalized terms in this Resolution shall have the meanings defined in the Ordinance and the Initial Assessment Resolution.

**SECTION 3. CREATION OF PIRATES WOOD ASSESSMENT AREA.** The Pirates Wood Assessment Area is hereby created to include: The Pirate's Wood Subdivision, being a portion of Section 43, Township 3 North, Range 28 East, Nassau County, Florida. The Assessment Area is created for the purpose of improving the use and enjoyment of property located therein by funding the construction of Road Improvements to benefit property located within the Assessment Area.

**SECTION 4. CONFIRMATION OF INITIAL ASSESSMENT RESOLUTION.** The Initial Assessment Resolution is hereby confirmed.

**SECTION 5. APPROVAL OF ASSESSMENT ROLL.** The Assessment Roll, a copy of which is attached hereto as Appendix E, is hereby approved.

**SECTION 6. ASSESSMENTS.**

(A) The Tax Parcels described in the Assessment Roll are hereby found to be specially benefitted by construction of the Road Improvements in the amount of the maximum annual Assessment set forth in the Assessment Roll. The methodology for computing annual Assessments described in the Initial Assessment Resolution is hereby approved. Annual Assessments computed in the manner described in the Initial Assessment Resolution are hereby levied and imposed on all Tax Parcels described in the Assessment

Roll at a maximum annual rate of \$410 per Parcel Unit for a period of 13 years, commencing with the ad valorem tax bill to be mailed in November 2001.

(B) Upon adoption of the Annual Assessment Resolution for each Fiscal Year, the Assessments shall constitute a lien against assessed property equal in rank and dignity with the liens of all state, county, district or municipal taxes and other non-ad valorem assessments. Except as otherwise provided by law, such lien shall be superior in dignity to all other liens, titles and claims, until paid. The lien shall be deemed perfected upon adoption by the Board of the Annual Assessment Resolution and shall attach to the property included on the Assessment Roll as of the prior January 1, the lien date for ad valorem taxes.

**SECTION 7.COLLECTION OF ASSESSMENTS.** The Assessments shall be collected pursuant to the Uniform Assessment Collection Act. Upon adoption of the Annual Assessment Resolution for each Fiscal Year, the County Coordinator shall cause the certification and delivery of the Assessment Roll to the Tax Collector by September 15, in the manner prescribed by the Uniform Assessment Collection Act. The Assessment Roll, as delivered to the Tax Collector, shall be accompanied by a Certificate of Non-Ad Valorem Assessment Roll in substantially the form attached hereto as Appendix F.

**SECTION 8.EFFECT OF FINAL ASSESSMENT RESOLUTION.** The adoption of this Final Assessment Resolution shall be the final adjudication of the issues presented herein and in the Initial Assessment Resolution (including, but not limited to, the method by which the Assessments will be computed, the Assessment Roll, the maximum

annual Assessment, the levy and lien of the Assessments and the terms for prepayment of the Assessments) unless proper steps are initiated in a court of competent jurisdiction to secure relief within twenty days from the date of Board action on this Final Assessment Resolution.

**SECTION 9. PREPAYMENT NOTICE.** The County Coordinator is hereby directed to provide notice by first class mail to the owner of each Tax Parcel described in the Assessment Roll of the opportunity to prepay all future annual Assessments, without financing cost. The notice, in substantially the form attached as Appendix C, shall be mailed to each property owner at the address utilized for the notice provided pursuant to Section 2.05 of the Initial Assessment Resolution.

**SECTION 10. ASSESSMENT NOTICE.** The County Coordinator is hereby directed to record a general notice of the Assessments in the Official Records Book in the office of the Nassau County Clerk of Courts. Such notice shall be in substantially the form attached as Appendix D. The preliminary Assessment Roll and each annual Assessment Roll shall be retained by the County Coordinator and shall be available for public inspection.

**SECTION 11. EFFECTIVE DATE.** This Resolution shall take effect immediately upon its adoption.

**DULY ADOPTED** this 16<sup>th</sup> day of July, 2001.

**BOARD OF COUNTY COMMISSIONERS  
OF NASSAU COUNTY, FLORIDA**

By:   
Marianne Marshall, Chairman

(SEAL)  
ATTEST:

By:   
J.M. "Chip" Oxley, Jr., Clerk

APPROVED AS TO FORM BY THE  
NASSAU COUNTY ATTORNEY

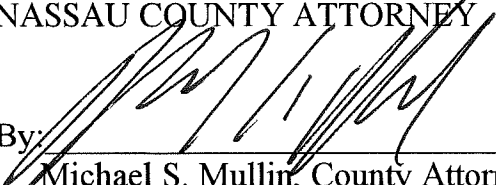
By:   
Michael S. Mullin, County Attorney

**APPENDIX A**

**PROOF OF PUBLICATION**

Pirates Wood Assessment Area

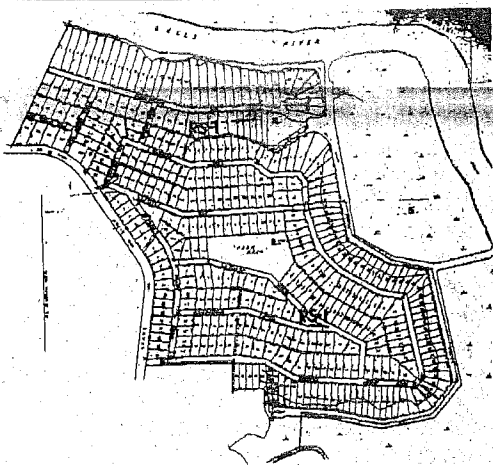

FLORIDA'S OLDEST WEEKLY NEWSPAPER

# NEWS LEADER

AMELIA ISLAND • FERNANDINA BEACH • NASSAU COUNTY

Published Weekly

511 Ash Street/P.O. Box 766 (904) 261-3696  
Fernandina Beach, Nassau County, Florida 32034

STATE OF FLORIDA  
COUNTY OF NASSAU:

Before the undersigned authority personally appeared  
**Robert O. Fiege**

Who on oath says that he is the Production Director of the Fernandina Beach News-Leader, a weekly newspaper published at Fernandina Beach in Nassau County, Florida; that the attached copy of advertisement, being a LEGAL DISPLAY ADVERTISEMENT in the matter of

**NOTICE OF HEARING TO IMPOSE AND PROVIDE FOR COLLECTION OF SPECIAL ASSESSMENTS In the Pirates Wood Assessment Area 7/16/01**

as published in said newspaper in the issues of  
**6/22,27/01**

Affiant further says that the said Fernandina Beach News-Leader is a newspaper published at Fernandina Beach, in said Nassau County, Florida and that the said newspaper has heretofore been continuously published in said Nassau County, Florida, each week and has been entered as second class mail matter at the post office in Fernandina Beach in said Nassau County, Florida, for a period of one year next preceding the first publication of the attached copy of advertisement; and Affiant further says that he has neither paid nor promised any person, firm or corporation any discount, rebate, commission or refund for the purpose of securing this advertisement for publication in the said newspaper.

Sworn to and subscribed before me  
This 5th day of JULY A.D. 2001.

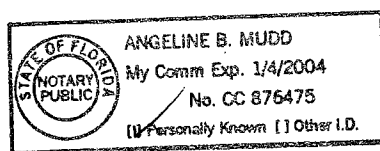
  
Angelina B. Mudd, Notary Public

## HEARING TO IMPOSE AND COLLECTION OF SPECIAL ASSESSMENTS PIRATES WOOD ASSESSMENT AREA

that the Nassau County Board of County public hearing to consider creation of the Pirates own above, and imposition of special assessments for improvements. The hearing will be held at 7:00 p.m., on County Building, located at 1336 Pages Dairy Road, of receiving public comment on the proposed assessment. All affected property owners have a right to appear at objections to the Board of County Commissioners Notice. If a person decides to appeal any decision Commissioners with respect to any matter considered. All need a record of the proceedings and may need to is made, including the testimony and evidence upon e. In accordance with the Americans with Disabilities accommodations or an interpreter to participate in this County's County Coordinator at 904/321-5782 at least e of the hearing.

h parcel of property will be based upon the total num- of record on the date the assessment is imposed. A re improvements and method of computing the assess- ty are set forth in the Initial Assessment Resolution ty Commissioners on May 14, 2001. Copies of the and the preliminary Assessment Roll are available at dinator, located at 3163 Bailey Road, Fernandina

e collected on the ad valorem tax bill, as authorized Statutes. Failure to pay the assessments will cause a inst the property which may result in a loss of title. ssioners intends to collect the assessments in fifteen first of which will be included on the ad valorem tax ; 2001.

ns, please contact the County Coordinator at 904/321-

BOARD OF COUNTY COMMISSIONERS  
NASSAU COUNTY, FLORIDA

MARIANNE MARSHALL  
Its: Chairman



**APPENDIX B**

**AFFIDAVIT OF MAILING**

## AFFIDAVIT OF MAILING

STATE OF FLORIDA  
COUNTY OF LEON

BEFORE ME, the undersigned authority, personally appeared Laura McKinley, who, after being duly sworn, deposes and says:

1. I, Laura McKinley, have been designated by the County Coordinator of Nassau County, Florida, to mail the notices required by Section 2.05 of Resolution No. 2001-74, adopted by the Board of County Commissioners of Nassau County, Florida, on May 14, 2001 (the "Initial Assessment Resolution").

2. On or before June 25, 2001, I mailed, or directed the mailing of, a notice in accordance with the Initial Assessment Resolution by first class mail, to each owner of property within the Pirates Wood Assessment Area in conformance with the requirements of Nassau County Ordinance No. 2000-37, at the address shown on the real property assessment tax roll maintained by the Nassau County Property Appraiser for the purpose of the levy and collection of ad valorem taxes.

FURTHER AFFIANT SAYETH NOT.

  
\_\_\_\_\_  
Affiant

STATE OF FLORIDA  
COUNTY OF LEON

The foregoing instrument was acknowledged before me by Laura McKinley, who is personally known to me, or who has produced \_\_\_\_\_ as identification and did (did not) take an oath.

WITNESS, my hand and official seal this 3rd day of July, A.D., 2001.



Terrie L. Ream  
Signature of person taking acknowledgment

\_\_\_\_\_  
Name of acknowledger (printed)

My commission expires: \_\_\_\_\_

**APPENDIX C**

**FORM OF PREPAYMENT NOTICE**

[LETTERHEAD - NASSAU COUNTY]

[Insert Date]

[Insert property reference information]

Dear Property Owner:

The Board of County Commissioners recently established and approved a special assessment for road and ancillary improvements within the Pirates Wood Assessment Area. This type of financing where the property owners participate in the cost of the program is used throughout Florida and is consistent with the policy in Nassau County.

The assessments will be collected on the ad valorem tax bill, as authorized by Section 197.3632, Florida Statutes. The assessments will be payable in \_\_\_ annual installments, the first of which shall be included on the ad valorem tax bill to be mailed in November 2001. Failure to pay the assessments will cause a tax certificate to be issued against the property which may result in a loss of title.

Any assessment may be prepaid in full, without interest or costs related to the County's incurrence of a loan to finance the road improvements, if payment is received on or prior to August \_\_, 2001. The amount required to prepay the assessment on or prior to August \_\_, 2001 is noted above and includes the tax parcel's share of the cost of the project and any charges related to implementing the assessments.

After August \_\_, 2001, the amount required to prepay the assessment will be increased to include costs related to the loan obtained by the County to finance the road improvements and interest on your prorata share of the loan from the date of prepayment to the next date following such prepayment on which the County can prepay the loan after providing all required notices.

[Please make checks for prepayment amounts payable to \_\_\_\_\_. Prepayment may be made by mail to \_\_\_\_\_, or in person at \_\_\_\_\_, located \_\_\_\_\_.] Please be sure to either write the assessment parcel number (shown at the top of this letter) on your check or return this letter with your payment.

Assessment records and copies of applicable Ordinances and Resolutions passed by the Board of County Commissioners are on file at the office of the County Coordinator, located at 3163 Bailey Road, Fernandina Beach, Florida.

**BOARD OF COUNTY COMMISSIONERS  
OF NASSAU COUNTY, FLORIDA**

**APPENDIX D**

**FORM OF ASSESSMENT NOTICE**

13

Return to: Joyce Bradley  
BCC

Doc# 200124713  
Book: 1665  
Pages: 475 - 487  
Filed & Recorded  
08/28/2001 10:22:39 AM  
J. M. OXLEY JR  
CLERK OF CIRCUIT COURT  
NASSAU COUNTY, FLORIDA  
RECORDING \$ 53.00  
TRUST FUND \$ 7.00

**NOTICE OF ASSESSMENTS**

Rec 60.00

On July 16, 2001, the Board of County Commissioners of Nassau County, Florida, adopted Resolution No. 2001-106, which imposed special assessments against property located within the Pirates Wood Assessment Area, which includes the property described in Section 3 of Resolution No. 2001-106, to finance road improvements. Attached as Exhibit A to this notice is a list of the affected tax parcel numbers and property owners (as shown on the Nassau County ad valorem tax assessment roll as of the effective date of Resolution No. 2001-106) and the number of parcel units attributable to each tax parcel. Annual assessments will be collected on the ad valorem tax bill, as authorized by Section 197.3632, Florida Statutes, for a period of 13 years, commencing with the ad valorem tax bill to be mailed in November 2001. The method of computing the annual assessment for any parcel of property to which the Property Appraiser has assigned a distinct ad valorem property tax identification number is set forth in Resolution No. 2001-74. The assessment roll, which identifies the number of parcel units attributable to each parcel of property is on file in the office of the County Coordinator and is open to public inspection. Resolution No. 2001-106 establishes a maximum annual assessment rate of \$410 per parcel unit.

This notice is recorded to provide constructive notice of the annual assessment to purchasers of property located within the Pirates Wood Assessment Area. Neither Resolution No. 2001-74, Resolution No. 2001-106 nor this notice will create a lien upon the property described above. The Board will adopt an annual assessment resolution for each fiscal year. Upon adoption of each annual assessment resolution, assessments shall



constitute a lien against assessed property equal in rank and dignity with the liens of all state, county, district or municipal taxes and other non-ad valorem assessments. The lien shall be deemed perfected upon adoption of each annual assessment resolution and shall attach to the property included on the assessment roll as of the prior January 1, the lien date for ad valorem taxes. This notice does not and shall not be construed to require that individual liens or releases be filed in the Official Records.

**BOARD OF COUNTY COMMISSIONERS  
OF NASSAU COUNTY, FLORIDA**

By:   
Marianne Marshall, Chairman

**EXHIBIT A**

**PIRATES WOOD ASSESSMENT AREA**

The following table includes tax parcel numbers included within the Pirates Wood Assessment Area, the property owner of each parcel (as shown on the Nassau County ad valorem tax assessment roll as of the effective date of Resolution No. 2001- 106) and the number of parcel units attributable to each parcel.

**Pirates Wood****Fiscal Year 2001-2002 Assessment**

<b>Parcel ID</b>	<b>Owner Name</b>	<b>Lots</b>
43-3N-28-509A-0001-0000	GRADY S JR & JOANN MAULDIN	2
43-3N-28-509A-0003-0000	D L & BETTY JOHN	1
43-3N-28-509A-0004-0000	KENNY C K & LORETTA WONG	1
43-3N-28-509A-0005-0000	CAROL B MULLER	1
43-3N-28-509A-0006-0000	MIRIAM MOONEY BEBERMAN	1
43-3N-28-509A-0007-0000	INGRID S HEINEMANN	1
43-3N-28-509A-0008-0000	JOYCE WARE WHITE	1
43-3N-28-509A-0009-0000	FRANKIE J NAIL	1
43-3N-28-509A-0010-0000	KEVIN J & ANH N ROBERTS	1
43-3N-28-509A-0011-0000	CHRISTOPHER S NELSON	1
43-3N-28-509A-0012-0000	RICHARD A & SANDRA R SAUL	1
43-3N-28-509A-0013-0000	ALBERT F NELSON	1
43-3N-28-509A-0014-0000	WADE RAULERSON	1
43-3N-28-509A-0015-0000	RICHARD R GERMANO	1
43-3N-28-509A-0016-0000	GENE W & JUNE L WELLS	1
43-3N-28-509A-0017-0000	GENE W & JUNE L WELLS	1
43-3N-28-509A-0018-0000	WILLIAM J MONROE	1
43-3N-28-509A-0019-0000	KENNIE E BRADDOCK	1
43-3N-28-509A-0020-0000	BEVERLY M WHITE	1
43-3N-28-509A-0022-0000	KENNIE E BRADDOCK	1
43-3N-28-509A-0023-0000	BETTY S EGAN	1
43-3N-28-509A-0024-0000	CARMA ROBINSON KERN	1
43-3N-28-509A-0025-0000	WARREN & LORETTA PEEPLES	1
43-3N-28-509A-0027-0000	WARREN & LORETTA PEEPLES	1
43-3N-28-509A-0028-0000	TRAVIS J & FANNIE M CARTER	1
43-3N-28-509A-0029-0000	DONALD & JACKIE R BAKER	1
43-3N-28-509A-0030-0000	JEFFREY D & CYNTHIA C HUGHES	1
43-3N-28-509A-0031-0000	KAREN R CLACK	1
43-3N-28-509A-0032-0000	BARRY B & DANIELLE G MCKENDREE	1
43-3N-28-509A-0033-0000	STEPHEN D WARREN	1

Parcel ID	Owner Name	Lots
43-3N-28-509A-0034-0000	RICHARD E JR & BETHEL L BOLTON	1
43-3N-28-509A-0035-0000	BETHEL L BOLTON	1
43-3N-28-509A-0036-0000	JOSEPH N WEHBY	1
43-3N-28-509A-0037-0000	MARY K BROWN	1
43-3N-28-509A-0039-0000	WALTER JR & TONYA ELIUM	1
43-3N-28-509A-0040-0000	WALTER D JR & TONYA H ELIUM	1
43-3N-28-509A-0041-0000	THOMAS & LORI ANN CENICOLA	1
43-3N-28-509A-0042-0000	ROBERT B NEVIN	1
43-3N-28-509A-0043-0000	THOMAS D & JACLYN J GUY	1
43-3N-28-509A-0044-0000	MARK & MARY M MINOTIS	1
43-3N-28-509A-0045-0000	VALERIE D NICHOLS	1
43-3N-28-509A-0046-0000	EDMOND F & PEGGY C BIERLEY	1
43-3N-28-509A-0047-0000	WILLIAM & RUTH CHICHEKIAN	1
43-3N-28-509A-0048-0000	JOHN N & JOAN G ITAK	1
43-3N-28-509A-0049-0000	GERALDINE DOPSON	1
43-3N-28-509A-0050-0000	RICK EDWARD DOPSON	1
43-3N-28-509A-0051-0000	WILLIAM LIGHTFOOT	1
43-3N-28-509A-0052-0000	LINDA WOOD	1
43-3N-28-509A-0053-0000	JOHN L & PATSY BUNCH	1
43-3N-28-509A-0054-0000	HARRY HUGHES	1
43-3N-28-509A-0055-0000	HARRY HUGHES	1
43-3N-28-509A-0056-0000	HARRY HUGHES	1
43-3N-28-509A-0057-0000	JAMES EVERETT & SUSAN W DAVIS	1
43-3N-28-509A-0058-0000	LARRY D & PEGGY H KENDRICK	1
43-3N-28-509A-0059-0000	JAMES H WARREN	1
43-3N-28-509A-0060-0000	RICHARD R GERMANO	1
43-3N-28-509A-0061-0000	ALBERT A & PHYLLIS M STODDARD	1
43-3N-28-509A-0062-0000	RONALD D & MARY W TROW	1
43-3N-28-509A-0063-0000	LAWRENCE R MOBLEY	1
43-3N-28-509A-0064-0000	WILLIAM J SR MONROE	1
43-3N-28-509A-0065-0000	WILLIAM J SR MONROE	1
43-3N-28-509A-0066-0000	GARY & BEVERLY KNAPPENBERGER	1
43-3N-28-509A-0067-0000	GARY & BEVERLY KNAPPENBERGER	1
43-3N-28-509A-0068-0000	GARY & BEVERLY KNAPPENBERGER	1
43-3N-28-509B-0001-0000	MICHEAL R & PHYLLIS H NADEAU	1

Parcel ID	Owner Name	Lots
43-3N-28-509B-0002-0000	RICHARD L & KRISTI D GOAR	1
43-3N-28-509B-0003-0000	PATRICK A & SARAH K MALEY	1
43-3N-28-509B-0004-0000	MATTHEW GRIFFIN	2
43-3N-28-509B-0006-0000	JULIE M PILLSBURY	1
43-3N-28-509B-0007-0000	EARLE C III & LISA B HULETT	1
43-3N-28-509B-0008-0000	EARLE C III & LISA B HULETT	1
43-3N-28-509B-0009-0000	SILAS W & WANDA T WORTH	1
43-3N-28-509B-0010-0000	MARVIN N JR & PATRICIA SMITH	1
43-3N-28-509B-0011-0000	LONNIE R & NANCY H STALCUP	1
43-3N-28-509B-0012-0000	LILLIAN G TAUSCHER	1
43-3N-28-509B-0014-0000	SARAH E POPE	1
43-3N-28-509B-0015-0000	TOMMY E & TAMMY R ANDERSON	1
43-3N-28-509B-0016-0000	WILLIAM & RUTH CHICHEKIAN	1
43-3N-28-509B-0017-0000	VENELDA V SERGENT	1
43-3N-28-509B-0018-0000	JOHN D & ALMA D PRUITT	1
43-3N-28-509B-0019-0000	ALSTYNE ROBERT T & MARY E VAN	1
43-3N-28-509B-0020-0000	DALE L AUCK	1
43-3N-28-509B-0021-0000	MAULDIN-COTTRELL INC	1
43-3N-28-509B-0022-0000	MAULDIN-COTTRELL INC	1
43-3N-28-509B-0023-0000	MAULDIN-COTTRELL INC	1
43-3N-28-509B-0024-0000	ROBERT & JUDIE TERRY	2
43-3N-28-509B-0026-0000	MATTHEW & TARA T HIGGINBOTHAM	1
43-3N-28-509B-0027-0000	WILLIAM B & EDITH W WORD	1
43-3N-28-509B-0028-0000	EDYTH HUBBARD	1
43-3N-28-509B-0029-0000	MIRIAM E BEBERMAN	1
43-3N-28-509B-0030-0000	JIM & DANNA CHATWELL	1
43-3N-28-509B-0031-0000	JAMES & KAREN L SALIS	1
43-3N-28-509B-0032-0000	LOUIS R GRIFFIN	1
43-3N-28-509B-0033-0000	HERBERT M & ROSALITTA W GRAHAM	1
43-3N-28-509B-0034-0000	ANTHONY LEE FISHER	1
43-3N-28-509B-0035-0000	HELEN A SMITH WEAVER	1
43-3N-28-509B-0036-0000	ROBERT & DELORES RATHBONE	1
43-3N-28-509B-0037-0000	RICHARD L & KRISTI D GOAR	1
43-3N-28-509B-0038-0000	BOBBY T & ANN MARIE STEVISON	1
43-3N-28-509B-0039-0000	PATRICK DUNLAP	1

Parcel ID	Owner Name	Lots
43-3N-28-509B-0040-0000	MAULDIN-COTTRELL INC	1
43-3N-28-509B-0041-0000	MAULDIN-COTTRELL INC	1
43-3N-28-509B-0042-0000	JOHN M & DELLA M SWANGER	1
43-3N-28-509B-0043-0000	JOHN M & DELLA M SWANGER	1
43-3N-28-509B-0044-0000	MAULDIN-COTTRELL INC	1
43-3N-28-509B-0045-0000	MAULDIN-COTTRELL INC	1
43-3N-28-509B-0046-0000	WILLIE W JR & DEBRA A WALKER	1
43-3N-28-509B-0047-0000	J J & J P O'CONNER	1
43-3N-28-509B-0048-0000	ROBERT & TERRY GRIFFIN	1
43-3N-28-509B-0049-0000	WILLIAM L & MARY F USSERY	1
43-3N-28-509B-0050-0000	MAULDIN-COTTRELL INC	1
43-3N-28-509B-0051-0000	GEORGE M & MERLE V SWEAT	1
43-3N-28-509B-0052-0000	KIRBY L & JANICE A HENDRIX	1
43-3N-28-509B-0053-0000	RAYMOND E & BENITA P SAPP	1
43-3N-28-509B-0054-0000	FRANK J & DIANE E CAMAROTTI	1
43-3N-28-509B-0055-0000	JAMES A III CORBETT	1
43-3N-28-509B-0056-0000	CAREY O & CAROLYN Y LYNCKER	1
43-3N-28-509B-0057-0000	ALLAN K WILLIAMS	1
43-3N-28-509B-0058-0000	ALLAN K WILLIAMS	1
43-3N-28-509B-0059-0000	DAVID & JENNIFER P SIRMANS	1
43-3N-28-509B-0060-0000	JOHN T & JANET L MCMAHAN	1
43-3N-28-509B-0061-0000	JONATHAN SELTZ	1
43-3N-28-509B-0062-0000	JOHN T JR & JANET L MCMAHAN	1
43-3N-28-509B-0063-0000	DAVID KEITH COTTRELL	1
43-3N-28-509C-0001-0000	GORDON & CAROL E PHILLIPS	1
43-3N-28-509C-0002-0000	DENNIS KAPPARIS	1
43-3N-28-509C-0003-0000	WILLIAM IRB BENNETT	1
43-3N-28-509C-0004-0000	MARIE R ESTES	1
43-3N-28-509C-0005-0000	GERALD W & PENNY I SUGGS	1
43-3N-28-509C-0006-0000	MAULDIN-COTTRELL INC	1
43-3N-28-509C-0007-0000	MAULDIN-COTTRELL INC	1
43-3N-28-509C-0008-0000	MAULDIN-COTTRELL INC	1
43-3N-28-509C-0009-0000	DONNA MARIE TOMKA BASS	1
43-3N-28-509C-0010-0000	ROBERT E & HAZEL E BRIGGS	1
43-3N-28-509C-0011-0000	ROBERT E & HAZEL E BRIGGS	1

Parcel ID	Owner Name	Lots
43-3N-28-509C-0012-0000	W STANLEY & CYNTHIA A MILES	1
43-3N-28-509C-0013-0000	HERBERT & MERRIMAE C MCFADDEN	1
43-3N-28-509C-0014-0000	ROBERT F BULOW	1
43-3N-28-509C-0015-0000	MARK C & LISA K PFIESTER	1
43-3N-28-509C-0016-0000	NORMAN K & MARJORIE H LUCIO	1
43-3N-28-509C-0017-0000	LARRY D & HOPE S DUGGAN	1
43-3N-28-509C-0018-0000	TRAVIS L & MICHELE CHAIRES	1
43-3N-28-509C-0019-0000	DWIGHT L & MARLA D SOUTHWELL	1
43-3N-28-509C-0020-0000	DAVID K & MARY ELLEN CORBIN	1
43-3N-28-509C-0021-0000	RICHARD M SEYLER	1
43-3N-28-509C-0022-0000	ORTRUD D FORSTER	1
43-3N-28-509C-0023-0000	DEAN BLAKE	1
43-3N-28-509C-0024-0000	DEAN BLAKE	1
43-3N-28-509C-0025-0000	DEAN BLAKE	2
43-3N-28-509C-0027-0000	NIELSON D & LORRAINE T STRONG	1
43-3N-28-509C-0028-0000	CHRISTOPHER T & RHONDA L BLAKE	1
43-3N-28-509C-0029-0000	CHRISTOPHER T & RHONDA L BLAKE	1
43-3N-28-509C-0030-0000	JAMES P & ROZLYN C WARREN	1
43-3N-28-509C-0031-0000	ROBERT BRENCHE & RAYE M PECK	1
43-3N-28-509C-0032-0000	RUSSELL C & JOYCE F BOWMAN	1
43-3N-28-509C-0033-0000	EDWARD A & MARY H ZACK	1
43-3N-28-509C-0034-0000	JOHN DARRELL LONG	2
43-3N-28-509C-0036-0000	RICHARD S & CAROLYN S RITTER	1
43-3N-28-509C-0037-0000	HARI & USHA SURAPANENI	1
43-3N-28-509C-0038-0000	HARRINGTON & CAROLINE MORRISON	1
43-3N-28-509C-0039-0000	KURT D & LERA L WULLENWEBER	1
43-3N-28-509C-0040-0000	AMANDA C JUBITO	1
43-3N-28-509C-0041-0000	RAYMOND G & J A PHILLIPS	1
43-3N-28-509C-0042-0000	SHIRLEY A POTEAT	1
43-3N-28-509C-0043-0000	SHIRLEY A POTEAT	1
43-3N-28-509C-0044-0000	SHIRLEY A POTEAT	1
43-3N-28-509C-0045-0000	JACK K CURTRIGHT	1
43-3N-28-509C-0046-0000	WARREN & LORETTA PEEPLES	1
43-3N-28-509C-0047-0000	WARREN & LORETTA PEEPLES	1
43-3N-28-509C-0048-0000	SHARON J REIN	2

Parcel ID	Owner Name	Lots
43-3N-28-509C-0050-0000	MARK A & KIM E KOSSAKOWSKI	1
43-3N-28-509C-0051-0000	JENNIFER ANN GREESON	1
43-3N-28-509C-0052-0000	DONNELL L MOBLEY	2
43-3N-28-509C-0054-0000	JACQUELINE M HARDING	1
43-3N-28-509C-0055-0000	DAVID W & SANDRA R FRAZIER	1
43-3N-28-509C-0056-0000	PATRICK CARROLL	1
43-3N-28-509C-0057-0000	PATRICK CARROLL	1
43-3N-28-509C-0058-0000	JAMES R III & BARBARA A PARKER	1
43-3N-28-509C-0059-0000	JACK D & SHARON M WATSON	1
43-3N-28-509C-0060-0000	JEFFREY EWALD HEAD	1
43-3N-28-509C-0061-0000	ROBIN R WILLIS	1
43-3N-28-509C-0062-0000	CHRISTINE C & STEVEN G MURRAY	1
43-3N-28-509C-0063-0000	ROBERT D & MARVILENE M SAGE	1
43-3N-28-509C-0064-0000	JEAN R MILES	1
43-3N-28-509C-0065-0000	MARK F & DONNA L GRIFFIN	1
43-3N-28-509C-0066-0000	BRUCE B & SHERRIE L NELSON	1
43-3N-28-509C-0067-0000	MARSHALL W & CAROL C ROWLAND	1
43-3N-28-509C-0068-0000	MAULDIN-COTTRELL INC	1
43-3N-28-509C-0069-0000	MAULDIN-COTTRELL INC	1
43-3N-28-509C-0070-0000	MAULDIN-COTTRELL INC	1
43-3N-28-509C-0071-0000	MAULDIN-COTTRELL INC	1
43-3N-28-509C-0072-0000	MICHAEL K & TERESA KENNEDY	1
43-3N-28-509C-0073-0000	PAUL D ALEXANDER	1
43-3N-28-509C-0074-0000	JOHN A FOX	1
43-3N-28-509C-0075-0000	PETER F & CHRISTINE M CHAPMAN	1
43-3N-28-509C-0076-0000	THOMAS N & MARGARET APPLEWHITE	1
43-3N-28-509C-0078-0000	WILLIAM & CONSTANCE SCHNIPPERT	2
43-3N-28-509C-0081-0000	WILLIAM A & PATRICIA A RYALS	1
43-3N-28-509C-0083-0000	WILLIAM A & PATRICIA A RYALS	1
43-3N-28-509C-0084-0000	WAYNE R & BEVERLY G STELLMACH	1
43-3N-28-509C-0085-0000	MARK DAVID CORBIN	1
43-3N-28-509C-0086-0000	DOUGLAS P DEMASI	1
43-3N-28-509C-0087-0000	JOHN & HONI BEA MATHEWS	1
43-3N-28-509C-0088-0000	ALLAN D FULLARD	1
43-3N-28-509C-0089-0000	JAMES B CATRON	2



Parcel ID	Owner Name	Lots
43-3N-28-509C-0091-0000	CHARLES S JR & BETTY J TOLIVER	1
43-3N-28-509C-0092-0000	GLADYS SANCHEZ	1
43-3N-28-509C-0093-0000	ROGER P & ALIENE C HURSEY	1
43-3N-28-509C-0094-0000	MAC PETTIT	1
43-3N-28-509C-0095-0000	GARY THRIFT	1
43-3N-28-509C-0096-0000	GARY B THRIFT	1
43-3N-28-509C-0097-0000	DOLORES M HOLMES	1
43-3N-28-509C-0098-0000	ANNETTE P MOBLEY	1
43-3N-28-509C-0099-0000	DEBORAH J BEASLEY	2
43-3N-28-509C-0101-0000	JOHN D ADAMS	2
43-3N-28-509C-0103-0000	MAULDIN-COTTRELL INC	1
43-3N-28-509C-0104-0000	PAUL L & SANDRA M MURRAY	1
43-3N-28-509C-0105-0000	GLENN M & LORI ANNE ROGERO	1
43-3N-28-509C-0106-0000	MAULDIN-COTTRELL INC	1
43-3N-28-509C-0107-0000	MAULDIN-COTTRELL INC	1
43-3N-28-509C-0108-0000	MAULDIN-COTTRELL INC	1
43-3N-28-509D-0001-0000	CHARLES & PATRICIA MOTT	1
43-3N-28-509D-0002-0000	VERNON W & JOAN A ZACHOW	2
43-3N-28-509D-0004-0000	JOHN L & VIVIAN L BROOKER	1
43-3N-28-509D-0005-0000	GEORGE C LAWRENCE	1
43-3N-28-509D-0006-0000	BELTON J & HIROKO LITTLEFIELD	1
43-3N-28-509D-0007-0000	CORRINE C NELSON	1
43-3N-28-509D-0008-0000	LAURIE J A SANDERSON	1
43-3N-28-509D-0009-0000	ROBERT DONALD & BARBARA M PECK	1
43-3N-28-509D-0010-0000	DAVID K & EDNA E FRASER	1
43-3N-28-509D-0011-0000	JOHNNIE T ENTER	1
43-3N-28-509D-0012-0000	EDWARD R & SALLY J KEES	1
43-3N-28-509D-0013-0000	ROBERT M & KIM R HARDING	1
43-3N-28-509D-0014-0000	JAMES H SR & SHIRLEY A LEAR	1
43-3N-28-509D-0015-0000	PETER L OLIVER	1
43-3N-28-509D-0016-0000	TERRANCE D & SHARON A HARMAN	1
43-3N-28-509D-0017-0000	R W & SANDRA A LIVINGSTON	1
43-3N-28-509D-0019-0000	GEORGE B & LINDA W BLAKE	2
43-3N-28-509D-0021-0000	M SUZANNE LANSDELL	1
43-3N-28-509D-0022-0000	CRAIG T & MAROLYN K HOLDER	1

Parcel ID	Owner Name	Lots
43-3N-28-509D-0023-0000	BARTON T & JEANNE M CLARK	1
43-3N-28-509D-0024-0000	RICHARD J & JANINE M BRUCE	1
43-3N-28-509D-0025-0000	JAMES M & TERESA L COMPANION	1
43-3N-28-509D-0026-0000	MARGUERITE R & JIMMY L COTTLE	1
43-3N-28-509D-0027-0000	JAMES R & JANICE G DAVIS	1
43-3N-28-509D-0028-0000	PETER L OLIVER	1
43-3N-28-509D-0029-0000	CHRISTOPHER T & RHONDA L BLAKE	1
43-3N-28-509D-0030-0000	CHRISTINE S NELSON	1
43-3N-28-509D-0031-0000	ROSA M ADAMS	1
43-3N-28-509D-0032-0000	LARRY W & PATRICIA L FOWLER	1
43-3N-28-509D-0033-0000	WILLIAM STEPHEN CAMPBELL	2
43-3N-28-509D-0035-0000	WARREN A & SHARON D DAVIS	1
43-3N-28-509D-0036-0000	WILLIAM F & CAROL L LONG	1
43-3N-28-509D-0038-0000	JULIE P TOMLINSON	1
43-3N-28-509D-0039-0000	LINDA R COURTENAY	2
43-3N-28-509D-0041-0000	DANIEL B TERRY	1
43-3N-28-509D-0042-0000	BRANDON & MARY BLACKMON	1
43-3N-28-509D-0043-0000	JOHN P & PAULA F JOHNSTON	1
43-3N-28-509D-0044-0000	FLOYD L & CHARLENE B LOHMAN	1
43-3N-28-509D-0046-0000	JOHN R & LANEY C HOPKINS	1
43-3N-28-509D-0047-0000	JAMES B CATRON	1
43-3N-28-509D-0048-0000	M ALENE DAVIS	1
43-3N-28-509D-0049-0000	JACKY F & WANDA SUE WATSON	1
43-3N-28-509D-0050-0000	JULIANA WRIGHT WEEKS	1
43-3N-28-509D-0051-0000	GEORGE R & T MARGARET REID	1
43-3N-28-509D-0052-0000	HARVEY K & ADRIANNE T WATSON	1
43-3N-28-509D-0053-0000	EVERETT E & DORINDA D BENTON	1
43-3N-28-509D-0054-0000	EVERETTE & RINDI BENTON	1
43-3N-28-509D-0055-0000	THOMAS D & JONI BRANAN	1
43-3N-28-509D-0056-0000	CHARLES R BRANAN	1
43-3N-28-509D-0057-0000	THOMAS J & BARBARA D BENNETT	1
43-3N-28-509D-0058-0000	THOMAS J & BARBARA D BENNETT	1
43-3N-28-509D-0059-0000	EDWARD B & JANET J MEADOWS	1
43-3N-28-509D-0061-0000	NANCY L JONES	2
43-3N-28-509D-0064-0000	J LAWSON JOHNSON	1

Parcel ID	Owner Name	Lots
43-3N-28-509D-0065-0000	CHARLIE M GREGORY	1
43-3N-28-509D-0066-0000	VICTOR F & MARY C YATES	1
43-3N-28-509D-0067-0000	ALMA F BERRYHILL	1
43-3N-28-509D-0068-0000	SHIRLEY A POTEAT	1
43-3N-28-509D-0069-0010	SHIRLEY A POTEAT	1
43-3N-28-509D-0069-0020	BENOIT N DEMERS	1
43-3N-28-509D-0071-0000	NEIL A NEVIN	1
43-3N-28-509D-0073-0000	ANDREW J & LEJENE ALLAN	1
43-3N-28-509D-0074-0000	KARIN A DOPSON	1
43-3N-28-509D-0075-0000	DAVID ALLEN DOUGLAS	1
43-3N-28-509E-0001-0000	HOMER L & CHARLOTTE P HUTTO	1
43-3N-28-509E-0002-0000	HOMER L & CHARLOTTE P HUTTO	1
43-3N-28-509E-0003-0000	HOMER L & CHARLOTTE P HUTTO	1
43-3N-28-509E-0004-0000	MAULDIN-COTTRELL INC	1
43-3N-28-509E-0005-0000	MAULDIN-COTTRELL INC	1
43-3N-28-509E-0006-0000	MAULDIN-COTTRELL INC	1
43-3N-28-509E-0007-0000	MAULDIN-COTTRELL INC	1
43-3N-28-509E-0008-0000	WM K BERGLUND	1
43-3N-28-509E-0009-0000	JAMES E & LINDA K CARTWRIGHT	1
43-3N-28-509E-0010-0000	BRUCE F & LINDA A FREEMAN	3
43-3N-28-509E-0013-0000	MAULDIN-COTTRELL INC	1
43-3N-28-509E-0014-0000	MAULDIN-COTTRELL INC	1
43-3N-28-509E-0015-0000	MAULDIN-COTTRELL INC	1
43-3N-28-509E-0016-0000	RAMON & DEBORAH ORTIZ	1
43-3N-28-509E-0017-0000	RAMON & DEBORAH ORTIZ	1
43-3N-28-509E-0018-0000	SUSAN P TILIAKOS	1
43-3N-28-509E-0019-0000	BRUCE C & WANDA BIERDS	1
43-3N-28-509F-0001-0000	ARMANEST W & PATSY J ENNIS	1
43-3N-28-509F-0002-0000	THE PACETTI GROUP, INC	1
43-3N-28-509F-0003-0000	CHAD LEE	1
43-3N-28-509F-0004-0000	MAULDIN-COTTRELL INC	1
43-3N-28-509F-0005-0000	CHRIS & DEAN V BLAKE	1
43-3N-28-509F-0006-0000	DAVID L TURNER	1
43-3N-28-509F-0007-0000	DAVID L TURNER	1
43-3N-28-509F-0008-0000	KELLEY KIDD	1

Parcel ID	Owner Name	Lots
43-3N-28-509F-0009-0000	GLYNWOOD & NELL S HORNE	1
43-3N-28-509F-0010-0000	ABELARDO & CONCEPCION MONDERO	1
43-3N-28-509F-0011-0000	DAMON E & MADEA M GORDON	1
43-3N-28-509F-0012-0000	DAMON E & MADEA M GORDON	1
43-3N-28-509F-0013-0000	KEVIN T & DANNA E MINER CRUMP	1
43-3N-28-509F-0014-0000	CHARLES R & RUBY L MEREDITH	1
43-3N-28-509F-0015-0000	PAUL C JR & EATHA MAE WILSON	1
43-3N-28-509F-0016-0000	ARTURO T & AURELIA MATABAN	1
43-3N-28-509F-0017-0000	HOMER L & CHARLOTTE P HUTTO	1
43-3N-28-509F-0018-0000	DAVID L TURNER	1
43-3N-28-509F-0019-0000	MAULDIN-COTTRELL INC	1
43-3N-28-509F-0020-0000	MAULDIN-COTTRELL INC	1
43-3N-28-509F-0021-0000	MAULDIN-COTTRELL INC	1
43-3N-28-509F-0022-0000	BERTHA L & EUGENE HUNTSINGER	1
43-3N-28-509F-0023-0000	DANIEL O & PATRICIA A RYALS	1
43-3N-28-509G-0001-0000	JAMES K CROFT	1
43-3N-28-509G-0002-0000	JAMES K CROFT	1
43-3N-28-509G-0003-0000	JAMES K CROFT	1
43-3N-28-509G-0004-0000	JAMES K CROFT	1
43-3N-28-509G-0005-0000	KERRY S WOODS	1
43-3N-28-509G-0006-0000	MARY K & KENNETH SNYDER	1
43-3N-28-509G-0007-0000	LORIN G COPPOCK	1
43-3N-28-509G-0008-0000	MARION E HAFTEL	1
43-3N-28-509G-0009-0000	WILLIAM L & LINDA R CRAVEY	1
Total Parcels: 334		352

**APPENDIX E**

**ASSESSMENT ROLL**

# Pirates Wood

## Fiscal Year 2001-2002 Assessment

<b>Parcel ID</b>	<b>Owner Name</b>	<b>Initial Prepayment</b>	<b>Adjusted Prepayment</b>	<b>Annual Assessment</b>
43-3N-28-509C-0101-0000	JOHN D ADAMS	\$5,255.69	\$5,909.11	\$807.75
43-3N-28-509D-0031-0000	ROSA M ADAMS	\$2,627.84	\$2,954.55	\$403.88
43-3N-28-509C-0073-0000	PAUL D ALEXANDER	\$2,627.84	\$2,954.55	\$403.88
43-3N-28-509D-0073-0000	ANDREW J & LEJENE ALLAN	\$2,627.84	\$2,954.55	\$403.88
43-3N-28-509B-0015-0000	TOMMY E & TAMMY R ANDERSON	\$2,627.84	\$2,954.55	\$403.88
43-3N-28-509C-0076-0000	THOMAS N & MARGARET APPLEWHITE	\$2,627.84	\$2,954.55	\$403.88
43-3N-28-509B-0020-0000	DALE L AUCK	\$2,627.84	\$2,954.55	\$403.88
43-3N-28-509A-0029-0000	DONALD & JACKIE R BAKER	\$2,627.84	\$2,954.55	\$403.88
43-3N-28-509C-0009-0000	DONNA MARIE TOMKA BASS	\$2,627.84	\$2,954.55	\$403.88
43-3N-28-509C-0099-0000	DEBORAH J BEASLEY	\$5,255.69	\$5,909.11	\$807.75
43-3N-28-509B-0029-0000	MIRIAM E BEBERMAN	\$2,627.84	\$2,954.55	\$403.88
43-3N-28-509A-0006-0000	MIRIAM MOONEY BEBERMAN	\$2,627.84	\$2,954.55	\$403.88
43-3N-28-509D-0057-0000	THOMAS J & BARBARA D BENNETT	\$2,627.84	\$2,954.55	\$403.88
43-3N-28-509D-0058-0000	THOMAS J & BARBARA D BENNETT	\$2,627.84	\$2,954.55	\$403.88
43-3N-28-509C-0003-0000	WILLIAM IRB BENNETT	\$2,627.84	\$2,954.55	\$403.88
43-3N-28-509D-0053-0000	EVERETT E & DORINDA D BENTON	\$2,627.84	\$2,954.55	\$403.88
43-3N-28-509D-0054-0000	EVERETTE & RINDI BENTON	\$2,627.84	\$2,954.55	\$403.88
43-3N-28-509E-0008-0000	WM K BERGLUND	\$2,627.84	\$2,954.55	\$403.88
43-3N-28-509D-0067-0000	ALMA F BERRYHILL	\$2,627.84	\$2,954.55	\$403.88
43-3N-28-509E-0019-0000	BRUCE C & WANDA BIERDS	\$2,627.84	\$2,954.55	\$403.88
43-3N-28-509A-0046-0000	EDMOND F & PEGGY C BIERLEY	\$2,627.84	\$2,954.55	\$403.88
43-3N-28-509D-0042-0000	BRANDON & MARY BLACKMON	\$2,627.84	\$2,954.55	\$403.88
43-3N-28-509F-0005-0000	CHRIS & DEAN V BLAKE	\$2,627.84	\$2,954.55	\$403.88
43-3N-28-509C-0028-0000	CHRISTOPHER T & RHONDA L BLAKE	\$2,627.84	\$2,954.55	\$403.88
43-3N-28-509C-0029-0000	CHRISTOPHER T & RHONDA L BLAKE	\$2,627.84	\$2,954.55	\$403.88
43-3N-28-509D-0029-0000	CHRISTOPHER T & RHONDA L BLAKE	\$2,627.84	\$2,954.55	\$403.88
43-3N-28-509C-0023-0000	DEAN BLAKE	\$2,627.84	\$2,954.55	\$403.88
43-3N-28-509C-0024-0000	DEAN BLAKE	\$2,627.84	\$2,954.55	\$403.88
43-3N-28-509C-0025-0000	DEAN BLAKE	\$5,255.69	\$5,909.11	\$807.75
43-3N-28-509D-0019-0000	GEORGE B & LINDA W BLAKE	\$5,255.69	\$5,909.11	\$807.75

<b>Parcel ID</b>	<b>Owner Name</b>	<b>Initial Prepayment</b>	<b>Adjusted Prepayment</b>	<b>Annual Assessment</b>
43-3N-28-509A-0035-0000	BETHEL L BOLTON	\$2,627.84	\$2,954.55	\$403.88
43-3N-28-509A-0034-0000	RICHARD E JR & BETHEL L BOLTON	\$2,627.84	\$2,954.55	\$403.88
43-3N-28-509C-0032-0000	RUSSELL C & JOYCE F BOWMAN	\$2,627.84	\$2,954.55	\$403.88
43-3N-28-509A-0019-0000	KENNIE E BRADDOCK	\$2,627.84	\$2,954.55	\$403.88
43-3N-28-509A-0022-0000	KENNIE E BRADDOCK	\$2,627.84	\$2,954.55	\$403.88
43-3N-28-509D-0056-0000	CHARLES R BRANAN	\$2,627.84	\$2,954.55	\$403.88
43-3N-28-509D-0055-0000	THOMAS D & JONI BRANAN	\$2,627.84	\$2,954.55	\$403.88
43-3N-28-509C-0010-0000	ROBERT E & HAZEL E BRIGGS	\$2,627.84	\$2,954.55	\$403.88
43-3N-28-509C-0011-0000	ROBERT E & HAZEL E BRIGGS	\$2,627.84	\$2,954.55	\$403.88
43-3N-28-509D-0004-0000	JOHN L & VIVIAN L BROOKER	\$2,627.84	\$2,954.55	\$403.88
43-3N-28-509A-0037-0000	MARY K BROWN	\$2,627.84	\$2,954.55	\$403.88
43-3N-28-509D-0024-0000	RICHARD J & JANINE M BRUCE	\$2,627.84	\$2,954.55	\$403.88
43-3N-28-509C-0014-0000	ROBERT F BULOW	\$2,627.84	\$2,954.55	\$403.88
43-3N-28-509A-0052-0000	LINDA WOOD	\$2,627.84	\$2,954.55	\$403.88
43-3N-28-509A-0053-0000	JOHN L & PATSY BUNCH	\$2,627.84	\$2,954.55	\$403.88
43-3N-28-509B-0054-0000	FRANK J & DIANE E CAMAROTTI	\$2,627.84	\$2,954.55	\$403.88
43-3N-28-509D-0033-0000	WILLIAM STEPHEN CAMPBELL	\$5,255.69	\$5,909.11	\$807.75
43-3N-28-509C-0056-0000	PATRICK CARROLL	\$2,627.84	\$2,954.55	\$403.88
43-3N-28-509C-0057-0000	PATRICK CARROLL	\$2,627.84	\$2,954.55	\$403.88
43-3N-28-509A-0028-0000	TRAVIS J & FANNIE M CARTER	\$2,627.84	\$2,954.55	\$403.88
43-3N-28-509E-0009-0000	JAMES E & LINDA K CARTWRIGHT	\$2,627.84	\$2,954.55	\$403.88
43-3N-28-509C-0089-0000	JAMES B CATRON	\$5,255.69	\$5,909.11	\$807.75
43-3N-28-509D-0047-0000	JAMES B CATRON	\$2,627.84	\$2,954.55	\$403.88
43-3N-28-509A-0041-0000	THOMAS & LORI ANN GENICOLA	\$2,627.84	\$2,954.55	\$403.88
43-3N-28-509C-0018-0000	TRAVIS L & MICHELE CHAIRES	\$2,627.84	\$2,954.55	\$403.88
43-3N-28-509C-0075-0000	PETER F & CHRISTINE M CHAPMAN	\$2,627.84	\$2,954.55	\$403.88
43-3N-28-509B-0030-0000	JIM & DANNA CHATWELL	\$2,627.84	\$2,954.55	\$403.88
43-3N-28-509A-0047-0000	WILLIAM & RUTH CHICHEKIAN	\$2,627.84	\$2,954.55	\$403.88
43-3N-28-509B-0016-0000	WILLIAM & RUTH CHICHEKIAN	\$2,627.84	\$2,954.55	\$403.88
43-3N-28-509A-0031-0000	KAREN R CLACK	\$2,627.84	\$2,954.55	\$403.88
43-3N-28-509D-0023-0000	BARTON T & JEANNE M CLARK	\$2,627.84	\$2,954.55	\$403.88
43-3N-28-509D-0025-0000	JAMES M & TERESA L COMPANION	\$2,627.84	\$2,954.55	\$403.88
43-3N-28-509G-0007-0000	LORIN G COPPOCK	\$2,627.84	\$2,954.55	\$403.88
43-3N-28-509B-0055-0000	JAMES A III CORBETT	\$2,627.84	\$2,954.55	\$403.88
43-3N-28-509C-0020-0000	DAVID K & MARY ELLEN CORBIN	\$2,627.84	\$2,954.55	\$403.88

<b>Parcel ID</b>	<b>Owner Name</b>	<b>Initial Prepayment</b>	<b>Adjusted Prepayment</b>	<b>Annual Assessment</b>
43-3N-28-509C-0085-0000	MARK DAVID CORBIN	\$2,627.84	\$2,954.55	\$403.88
43-3N-28-509D-0026-0000	MARGUERITE R & JIMMY L COTTLE	\$2,627.84	\$2,954.55	\$403.88
43-3N-28-509B-0063-0000	DAVID KEITH COTTRELL	\$2,627.84	\$2,954.55	\$403.88
43-3N-28-509D-0039-0000	LINDA R COURTENAY	\$5,255.69	\$5,909.11	\$807.75
43-3N-28-509G-0009-0000	WILLIAM L & LINDA R CRAVEY	\$2,627.84	\$2,954.55	\$403.88
43-3N-28-509G-0001-0000	JAMES K CROFT	\$2,627.84	\$2,954.55	\$403.88
43-3N-28-509G-0002-0000	JAMES K CROFT	\$2,627.84	\$2,954.55	\$403.88
43-3N-28-509G-0003-0000	JAMES K CROFT	\$2,627.84	\$2,954.55	\$403.88
43-3N-28-509G-0004-0000	JAMES K CROFT	\$2,627.84	\$2,954.55	\$403.88
43-3N-28-509F-0013-0000	KEVIN T & DANNA E MINER CRUMP	\$2,627.84	\$2,954.55	\$403.88
43-3N-28-509C-0045-0000	JACK K CURTRIGHT	\$2,627.84	\$2,954.55	\$403.88
43-3N-28-509A-0057-0000	JAMES EVERETT & SUSAN W DAVIS	\$2,627.84	\$2,954.55	\$403.88
43-3N-28-509D-0027-0000	JAMES R & JANICE G DAVIS	\$2,627.84	\$2,954.55	\$403.88
43-3N-28-509D-0048-0000	M ALENE DAVIS	\$2,627.84	\$2,954.55	\$403.88
43-3N-28-509D-0035-0000	WARREN A & SHARON D DAVIS	\$2,627.84	\$2,954.55	\$403.88
43-3N-28-509C-0086-0000	DOUGLAS P DEMASI	\$2,627.84	\$2,954.55	\$403.88
43-3N-28-509D-0069-0020	BENOIT N DEMERS	\$2,627.84	\$2,954.55	\$403.88
43-3N-28-509A-0049-0000	GERALDINE DOPSON	\$2,627.84	\$2,954.55	\$403.88
43-3N-28-509D-0074-0000	KARIN A DOPSON	\$2,627.84	\$2,954.55	\$403.88
43-3N-28-509A-0050-0000	RICK EDWARD DOPSON	\$2,627.84	\$2,954.55	\$403.88
43-3N-28-509D-0075-0000	DAVID ALLEN DOUGLAS	\$2,627.84	\$2,954.55	\$403.88
43-3N-28-509C-0017-0000	LARRY D & HOPE S DUGGAN	\$2,627.84	\$2,954.55	\$403.88
43-3N-28-509B-0039-0000	PATRICK DUNLAP	\$2,627.84	\$2,954.55	\$403.88
43-3N-28-509A-0023-0000	BETTY S EGAN	\$2,627.84	\$2,954.55	\$403.88
43-3N-28-509A-0040-0000	WALTER D JR & TONYA H ELIUM	\$2,627.84	\$2,954.55	\$403.88
43-3N-28-509A-0039-0000	WALTER JR & TONYA ELIUM	\$2,627.84	\$2,954.55	\$403.88
43-3N-28-509F-0001-0000	ARMANEST W & PATSY J ENNIS	\$2,627.84	\$2,954.55	\$403.88
43-3N-28-509D-0011-0000	JOHNNIE T ENTER	\$2,627.84	\$2,954.55	\$403.88
43-3N-28-509C-0004-0000	MARIE R ESTES	\$2,627.84	\$2,954.55	\$403.88
43-3N-28-509B-0034-0000	ANTHONY LEE FISHER	\$2,627.84	\$2,954.55	\$403.88
43-3N-28-509C-0022-0000	ORTRUD D FORSTER	\$2,627.84	\$2,954.55	\$403.88
43-3N-28-509D-0032-0000	LARRY W & PATRICIA L FOWLER	\$2,627.84	\$2,954.55	\$403.88
43-3N-28-509C-0074-0000	JOHN A FOX	\$2,627.84	\$2,954.55	\$403.88
43-3N-28-509D-0010-0000	DAVID K & EDNA E FRASER	\$2,627.84	\$2,954.55	\$403.88
43-3N-28-509C-0055-0000	DAVID W & SANDRA R FRAZIER	\$2,627.84	\$2,954.55	\$403.88



<b>Parcel ID</b>	<b>Owner Name</b>	<b>Initial Prepayment</b>	<b>Adjusted Prepayment</b>	<b>Annual Assessment</b>
43-3N-28-509E-0010-0000	BRUCE F & LINDA A FREEMAN	\$7,883.53	\$8,863.65	\$1,211.62
43-3N-28-509C-0088-0000	ALLAN D FULLARD	\$2,627.84	\$2,954.55	\$403.88
43-3N-28-509A-0015-0000	RICHARD R GERMANO	\$2,627.84	\$2,954.55	\$403.88
43-3N-28-509A-0060-0000	RICHARD R GERMANO	\$2,627.84	\$2,954.55	\$403.88
43-3N-28-509B-0002-0000	RICHARD L & KRISTI D GOAR	\$2,627.84	\$2,954.55	\$403.88
43-3N-28-509B-0037-0000	RICHARD L & KRISTI D GOAR	\$2,627.84	\$2,954.55	\$403.88
43-3N-28-509F-0011-0000	DAMON E & MADEA M GORDON	\$2,627.84	\$2,954.55	\$403.88
43-3N-28-509F-0012-0000	DAMON E & MADEA M GORDON	\$2,627.84	\$2,954.55	\$403.88
43-3N-28-509B-0033-0000	HERBERT M & ROSALITTA W GRAHAM	\$2,627.84	\$2,954.55	\$403.88
43-3N-28-509C-0051-0000	JENNIFER ANN GREESON	\$2,627.84	\$2,954.55	\$403.88
43-3N-28-509D-0065-0000	CHARLIE M GREGORY	\$2,627.84	\$2,954.55	\$403.88
43-3N-28-509B-0032-0000	LOUIS R GRIFFIN	\$2,627.84	\$2,954.55	\$403.88
43-3N-28-509C-0065-0000	MARK F & DONNA L GRIFFIN	\$2,627.84	\$2,954.55	\$403.88
43-3N-28-509B-0004-0000	MATTHEW GRIFFIN	\$5,255.69	\$5,909.11	\$807.75
43-3N-28-509B-0048-0000	ROBERT & TERRY GRIFFIN	\$2,627.84	\$2,954.55	\$403.88
43-3N-28-509A-0043-0000	THOMAS D & JACLYN J GUY	\$2,627.84	\$2,954.55	\$403.88
43-3N-28-509G-0008-0000	MARION E HAFTEL	\$2,627.84	\$2,954.55	\$403.88
43-3N-28-509C-0054-0000	JACQUELINE M HARDING	\$2,627.84	\$2,954.55	\$403.88
43-3N-28-509D-0013-0000	ROBERT M & KIM R HARDING	\$2,627.84	\$2,954.55	\$403.88
43-3N-28-509D-0016-0000	TERRANCE D & SHARON A HARMAN	\$2,627.84	\$2,954.55	\$403.88
43-3N-28-509C-0060-0000	JEFFREY EWALD HEAD	\$2,627.84	\$2,954.55	\$403.88
43-3N-28-509A-0007-0000	INGRID S HEINEMANN	\$2,627.84	\$2,954.55	\$403.88
43-3N-28-509B-0052-0000	KIRBY L & JANICE A HENDRIX	\$2,627.84	\$2,954.55	\$403.88
43-3N-28-509B-0026-0000	MATTHEW & TARA T HIGGINBOTHAM	\$2,627.84	\$2,954.55	\$403.88
43-3N-28-509D-0022-0000	CRAIG T & MAROLYN K HOLDER	\$2,627.84	\$2,954.55	\$403.88
43-3N-28-509C-0097-0000	DOLORES M HOLMES	\$2,627.84	\$2,954.55	\$403.88
43-3N-28-509D-0046-0000	JOHN R & LANEY C HOPKINS	\$2,627.84	\$2,954.55	\$403.88
43-3N-28-509F-0009-0000	GLYNWOOD & NELL S HORNE	\$2,627.84	\$2,954.55	\$403.88
43-3N-28-509B-0028-0000	EDYTH HUBBARD	\$2,627.84	\$2,954.55	\$403.88
43-3N-28-509A-0054-0000	HARRY HUGHES	\$2,627.84	\$2,954.55	\$403.88
43-3N-28-509A-0055-0000	HARRY HUGHES	\$2,627.84	\$2,954.55	\$403.88
43-3N-28-509A-0056-0000	HARRY HUGHES	\$2,627.84	\$2,954.55	\$403.88
43-3N-28-509A-0030-0000	JEFFREY D & CYNTHIA C HUGHES	\$2,627.84	\$2,954.55	\$403.88
43-3N-28-509B-0007-0000	EARLE C III & LISA B HULETT	\$2,627.84	\$2,954.55	\$403.88
43-3N-28-509B-0008-0000	EARLE C III & LISA B HULETT	\$2,627.84	\$2,954.55	\$403.88

<b>Parcel ID</b>	<b>Owner Name</b>	<b>Initial Prepayment</b>	<b>Adjusted Prepayment</b>	<b>Annual Assessment</b>
43-3N-28-509F-0022-0000	BERTHA L & EUGENE HUNTSINGER	\$2,627.84	\$2,954.55	\$403.88
43-3N-28-509C-0093-0000	ROGER P & ALIENE C HURSEY	\$2,627.84	\$2,954.55	\$403.88
43-3N-28-509E-0001-0000	HOMER L & CHARLOTTE P HUTTO	\$2,627.84	\$2,954.55	\$403.88
43-3N-28-509E-0002-0000	HOMER L & CHARLOTTE P HUTTO	\$2,627.84	\$2,954.55	\$403.88
43-3N-28-509E-0003-0000	HOMER L & CHARLOTTE P HUTTO	\$2,627.84	\$2,954.55	\$403.88
43-3N-28-509F-0017-0000	HOMER L & CHARLOTTE P HUTTO	\$2,627.84	\$2,954.55	\$403.88
43-3N-28-509A-0048-0000	JOHN N & JOAN G ITAK	\$2,627.84	\$2,954.55	\$403.88
43-3N-28-509A-0003-0000	D L & BETTY JOHN	\$2,627.84	\$2,954.55	\$403.88
43-3N-28-509D-0064-0000	J LAWSON JOHNSON	\$2,627.84	\$2,954.55	\$403.88
43-3N-28-509D-0043-0000	JOHN P & PAULA F JOHNSTON	\$2,627.84	\$2,954.55	\$403.88
43-3N-28-509D-0061-0000	NANCY L JONES	\$5,255.69	\$5,909.11	\$807.75
43-3N-28-509C-0040-0000	AMANDA C JUBITO	\$2,627.84	\$2,954.55	\$403.88
43-3N-28-509C-0002-0000	DENNIS KAPPARIS	\$2,627.84	\$2,954.55	\$403.88
43-3N-28-509D-0012-0000	EDWARD R & SALLY J KEES	\$2,627.84	\$2,954.55	\$403.88
43-3N-28-509A-0058-0000	LARRY D & PEGGY H KENDRICK	\$2,627.84	\$2,954.55	\$403.88
43-3N-28-509C-0072-0000	MICHAEL K & TERESA KENNEDY	\$2,627.84	\$2,954.55	\$403.88
43-3N-28-509A-0024-0000	CARMA ROBINSON KERN	\$2,627.84	\$2,954.55	\$403.88
43-3N-28-509F-0008-0000	KELLEY KIDD	\$2,627.84	\$2,954.55	\$403.88
43-3N-28-509A-0066-0000	GARY & BEVERLY KNAPPENBERGER	\$2,627.84	\$2,954.55	\$403.88
43-3N-28-509A-0067-0000	GARY & BEVERLY KNAPPENBERGER	\$2,627.84	\$2,954.55	\$403.88
43-3N-28-509A-0068-0000	GARY & BEVERLY KNAPPENBERGER	\$2,627.84	\$2,954.55	\$403.88
43-3N-28-509C-0050-0000	MARK A & KIM E KOSSAKOWSKI	\$2,627.84	\$2,954.55	\$403.88
43-3N-28-509D-0021-0000	M SUZANNE LANSDELL	\$2,627.84	\$2,954.55	\$403.88
43-3N-28-509D-0005-0000	GEORGE C LAWRENCE	\$2,627.84	\$2,954.55	\$403.88
43-3N-28-509D-0014-0000	JAMES H SR & SHIRLEY A LEAR	\$2,627.84	\$2,954.55	\$403.88
43-3N-28-509F-0003-0000	CHAD LEE	\$2,627.84	\$2,954.55	\$403.88
43-3N-28-509A-0051-0000	WILLIAM LIGHTFOOT	\$2,627.84	\$2,954.55	\$403.88
43-3N-28-509D-0006-0000	BELTON J & HIROKO LITTLEFIELD	\$2,627.84	\$2,954.55	\$403.88
43-3N-28-509D-0017-0000	R W & SANDRA A LIVINGSTON	\$2,627.84	\$2,954.55	\$403.88
43-3N-28-509D-0044-0000	FLOYD L & CHARLENE B LOHMAN	\$2,627.84	\$2,954.55	\$403.88
43-3N-28-509C-0034-0000	JOHN DARRELL LONG	\$5,255.69	\$5,909.11	\$807.75
43-3N-28-509D-0036-0000	WILLIAM F & CAROL L LONG	\$2,627.84	\$2,954.55	\$403.88
43-3N-28-509C-0016-0000	NORMAN K & MARJORIE H LUCIO	\$2,627.84	\$2,954.55	\$403.88
43-3N-28-509B-0056-0000	CAREY O & CAROLYN Y LYNCKER	\$2,627.84	\$2,954.55	\$403.88
43-3N-28-509B-0003-0000	PATRICK A & SARAH K MALEY	\$2,627.84	\$2,954.55	\$403.88

<b>Parcel ID</b>	<b>Owner Name</b>	<b>Initial Prepayment</b>	<b>Adjusted Prepayment</b>	<b>Annual Assessment</b>
43-3N-28-509F-0016-0000	ARTURO T & AURELIA MATABAN	\$2,627.84	\$2,954.55	\$403.88
43-3N-28-509C-0087-0000	JOHN & HONI BEA MATHEWS	\$2,627.84	\$2,954.55	\$403.88
43-3N-28-509A-0001-0000	GRADY S JR & JOANN MAULDIN	\$5,255.69	\$5,909.11	\$807.75
43-3N-28-509B-0021-0000	MAULDIN-COTTRELL INC	\$2,627.84	\$2,954.55	\$403.88
43-3N-28-509B-0022-0000	MAULDIN-COTTRELL INC	\$2,627.84	\$2,954.55	\$403.88
43-3N-28-509B-0023-0000	MAULDIN-COTTRELL INC	\$2,627.84	\$2,954.55	\$403.88
43-3N-28-509B-0040-0000	MAULDIN-COTTRELL INC	\$2,627.84	\$2,954.55	\$403.88
43-3N-28-509B-0041-0000	MAULDIN-COTTRELL INC	\$2,627.84	\$2,954.55	\$403.88
43-3N-28-509B-0044-0000	MAULDIN-COTTRELL INC	\$2,627.84	\$2,954.55	\$403.88
43-3N-28-509B-0045-0000	MAULDIN-COTTRELL INC	\$2,627.84	\$2,954.55	\$403.88
43-3N-28-509B-0050-0000	MAULDIN-COTTRELL INC	\$2,627.84	\$2,954.55	\$403.88
43-3N-28-509C-0006-0000	MAULDIN-COTTRELL INC	\$2,627.84	\$2,954.55	\$403.88
43-3N-28-509C-0007-0000	MAULDIN-COTTRELL INC	\$2,627.84	\$2,954.55	\$403.88
43-3N-28-509C-0008-0000	MAULDIN-COTTRELL INC	\$2,627.84	\$2,954.55	\$403.88
43-3N-28-509C-0068-0000	MAULDIN-COTTRELL INC	\$2,627.84	\$2,954.55	\$403.88
43-3N-28-509C-0069-0000	MAULDIN-COTTRELL INC	\$2,627.84	\$2,954.55	\$403.88
43-3N-28-509C-0070-0000	MAULDIN-COTTRELL INC	\$2,627.84	\$2,954.55	\$403.88
43-3N-28-509C-0071-0000	MAULDIN-COTTRELL INC	\$2,627.84	\$2,954.55	\$403.88
43-3N-28-509C-0103-0000	MAULDIN-COTTRELL INC	\$2,627.84	\$2,954.55	\$403.88
43-3N-28-509C-0106-0000	MAULDIN-COTTRELL INC	\$2,627.84	\$2,954.55	\$403.88
43-3N-28-509C-0107-0000	MAULDIN-COTTRELL INC	\$2,627.84	\$2,954.55	\$403.88
43-3N-28-509C-0108-0000	MAULDIN-COTTRELL INC	\$2,627.84	\$2,954.55	\$403.88
43-3N-28-509E-0004-0000	MAULDIN-COTTRELL INC	\$2,627.84	\$2,954.55	\$403.88
43-3N-28-509E-0005-0000	MAULDIN-COTTRELL INC	\$2,627.84	\$2,954.55	\$403.88
43-3N-28-509E-0006-0000	MAULDIN-COTTRELL INC	\$2,627.84	\$2,954.55	\$403.88
43-3N-28-509E-0007-0000	MAULDIN-COTTRELL INC	\$2,627.84	\$2,954.55	\$403.88
43-3N-28-509E-0013-0000	MAULDIN-COTTRELL INC	\$2,627.84	\$2,954.55	\$403.88
43-3N-28-509E-0014-0000	MAULDIN-COTTRELL INC	\$2,627.84	\$2,954.55	\$403.88
43-3N-28-509E-0015-0000	MAULDIN-COTTRELL INC	\$2,627.84	\$2,954.55	\$403.88
43-3N-28-509F-0004-0000	MAULDIN-COTTRELL INC	\$2,627.84	\$2,954.55	\$403.88
43-3N-28-509F-0019-0000	MAULDIN-COTTRELL INC	\$2,627.84	\$2,954.55	\$403.88
43-3N-28-509F-0020-0000	MAULDIN-COTTRELL INC	\$2,627.84	\$2,954.55	\$403.88
43-3N-28-509F-0021-0000	MAULDIN-COTTRELL INC	\$2,627.84	\$2,954.55	\$403.88
43-3N-28-509C-0013-0000	HERBERT & MERRIMAE C MCFADDEN	\$2,627.84	\$2,954.55	\$403.88
43-3N-28-509A-0032-0000	BARRY B & DANIELLE G MCKENDREE	\$2,627.84	\$2,954.55	\$403.88

<b>Parcel ID</b>	<b>Owner Name</b>	<b>Initial Prepayment</b>	<b>Adjusted Prepayment</b>	<b>Annual Assessment</b>
43-3N-28-509B-0060-0000	JOHN T & JANET L MCMAHAN	\$2,627.84	\$2,954.55	\$403.88
43-3N-28-509B-0062-0000	JOHN T JR & JANET L MCMAHAN	\$2,627.84	\$2,954.55	\$403.88
43-3N-28-509D-0059-0000	EDWARD B & JANET J MEADOWS	\$2,627.84	\$2,954.55	\$403.88
43-3N-28-509F-0014-0000	CHARLES R & RUBY L MEREDITH	\$2,627.84	\$2,954.55	\$403.88
43-3N-28-509C-0064-0000	JEAN R MILES	\$2,627.84	\$2,954.55	\$403.88
43-3N-28-509C-0012-0000	W STANLEY & CYNTHIA A MILES	\$2,627.84	\$2,954.55	\$403.88
43-3N-28-509A-0044-0000	MARK & MARY M MINOTIS	\$2,627.84	\$2,954.55	\$403.88
43-3N-28-509C-0098-0000	ANNETTE P MOBLEY	\$2,627.84	\$2,954.55	\$403.88
43-3N-28-509C-0052-0000	DONNELL L MOBLEY	\$5,255.69	\$5,909.11	\$807.75
43-3N-28-509A-0063-0000	LAWRENCE R MOBLEY	\$2,627.84	\$2,954.55	\$403.88
43-3N-28-509F-0010-0000	ABELARDO & CONCEPCION MONDERO	\$2,627.84	\$2,954.55	\$403.88
43-3N-28-509A-0018-0000	WILLIAM J MONROE	\$2,627.84	\$2,954.55	\$403.88
43-3N-28-509A-0064-0000	WILLIAM J SR MONROE	\$2,627.84	\$2,954.55	\$403.88
43-3N-28-509A-0065-0000	WILLIAM J SR MONROE	\$2,627.84	\$2,954.55	\$403.88
43-3N-28-509C-0038-0000	HARRINGTON & CAROLINE MORRISON	\$2,627.84	\$2,954.55	\$403.88
43-3N-28-509D-0001-0000	CHARLES & PATRICIA MOTT	\$2,627.84	\$2,954.55	\$403.88
43-3N-28-509A-0005-0000	CAROL B MULLER	\$2,627.84	\$2,954.55	\$403.88
43-3N-28-509C-0062-0000	CHRISTINE C & STEVEN G MURRAY	\$2,627.84	\$2,954.55	\$403.88
43-3N-28-509C-0104-0000	PAUL L & SANDRA M MURRAY	\$2,627.84	\$2,954.55	\$403.88
43-3N-28-509B-0001-0000	MICHEAL R & PHYLLIS H NADEAU	\$2,627.84	\$2,954.55	\$403.88
43-3N-28-509A-0009-0000	FRANKIE J NAIL	\$2,627.84	\$2,954.55	\$403.88
43-3N-28-509A-0013-0000	ALBERT F NELSON	\$2,627.84	\$2,954.55	\$403.88
43-3N-28-509C-0066-0000	BRUCE B & SHERRIE L NELSON	\$2,627.84	\$2,954.55	\$403.88
43-3N-28-509D-0030-0000	CHRISTINE S NELSON	\$2,627.84	\$2,954.55	\$403.88
43-3N-28-509A-0011-0000	CHRISTOPHER S NELSON	\$2,627.84	\$2,954.55	\$403.88
43-3N-28-509D-0007-0000	CORRINE C NELSON	\$2,627.84	\$2,954.55	\$403.88
43-3N-28-509D-0071-0000	NEIL A NEVIN	\$2,627.84	\$2,954.55	\$403.88
43-3N-28-509A-0042-0000	ROBERT B NEVIN	\$2,627.84	\$2,954.55	\$403.88
43-3N-28-509A-0045-0000	VALERIE D NICHOLS	\$2,627.84	\$2,954.55	\$403.88
43-3N-28-509B-0047-0000	J J & J P O'CONNOR	\$2,627.84	\$2,954.55	\$403.88
43-3N-28-509D-0015-0000	PETER L OLIVER	\$2,627.84	\$2,954.55	\$403.88
43-3N-28-509D-0028-0000	PETER L OLIVER	\$2,627.84	\$2,954.55	\$403.88
43-3N-28-509E-0016-0000	RAMON & DEBORAH ORTIZ	\$2,627.84	\$2,954.55	\$403.88
43-3N-28-509E-0017-0000	RAMON & DEBORAH ORTIZ	\$2,627.84	\$2,954.55	\$403.88
43-3N-28-509F-0002-0000	THE PACETTI GROUP, INC	\$2,627.84	\$2,954.55	\$403.88

<b>Parcel ID</b>	<b>Owner Name</b>	<b>Initial Prepayment</b>	<b>Adjusted Prepayment</b>	<b>Annual Assessment</b>
43-3N-28-509C-0058-0000	JAMES R III & BARBARA A PARKER	\$2,627.84	\$2,954.55	\$403.88
43-3N-28-509C-0031-0000	ROBERT BRENCE & RAYE M PECK	\$2,627.84	\$2,954.55	\$403.88
43-3N-28-509D-0009-0000	ROBERT DONALD & BARBARA M PECK	\$2,627.84	\$2,954.55	\$403.88
43-3N-28-509A-0025-0000	WARREN & LORETTA PEEPLES	\$2,627.84	\$2,954.55	\$403.88
43-3N-28-509A-0027-0000	WARREN & LORETTA PEEPLES	\$2,627.84	\$2,954.55	\$403.88
43-3N-28-509C-0046-0000	WARREN & LORETTA PEEPLES	\$2,627.84	\$2,954.55	\$403.88
43-3N-28-509C-0047-0000	WARREN & LORETTA PEEPLES	\$2,627.84	\$2,954.55	\$403.88
43-3N-28-509C-0094-0000	MAC PETTIT	\$2,627.84	\$2,954.55	\$403.88
43-3N-28-509C-0015-0000	MARK C & LISA K PFIESTER	\$2,627.84	\$2,954.55	\$403.88
43-3N-28-509C-0001-0000	GORDON & CAROL E PHILLIPS	\$2,627.84	\$2,954.55	\$403.88
43-3N-28-509C-0041-0000	RAYMOND G & J A PHILLIPS	\$2,627.84	\$2,954.55	\$403.88
43-3N-28-509B-0006-0000	JULIE M PILLSBURY	\$2,627.84	\$2,954.55	\$403.88
43-3N-28-509B-0014-0000	SARAH E POPE	\$2,627.84	\$2,954.55	\$403.88
43-3N-28-509D-0068-0000	SHIRLEY A POTEAT	\$2,627.84	\$2,954.55	\$403.88
43-3N-28-509D-0069-0010	SHIRLEY A POTEAT	\$2,627.84	\$2,954.55	\$403.88
43-3N-28-509C-0042-0000	SHIRLEY A POTEAT	\$2,627.84	\$2,954.55	\$403.88
43-3N-28-509C-0043-0000	SHIRLEY A POTEAT	\$2,627.84	\$2,954.55	\$403.88
43-3N-28-509C-0044-0000	SHIRLEY A POTEAT	\$2,627.84	\$2,954.55	\$403.88
43-3N-28-509B-0018-0000	JOHN D & ALMA D PRUITT	\$2,627.84	\$2,954.55	\$403.88
43-3N-28-509B-0036-0000	ROBERT & DELORES RATHBONE	\$2,627.84	\$2,954.55	\$403.88
43-3N-28-509A-0014-0000	WADE RAULERSON	\$2,627.84	\$2,954.55	\$403.88
43-3N-28-509D-0051-0000	GEORGE R & T MARGARET REID	\$2,627.84	\$2,954.55	\$403.88
43-3N-28-509C-0048-0000	SHARON J REIN	\$5,255.69	\$5,909.11	\$807.75
43-3N-28-509C-0036-0000	RICHARD S & CAROLYN S RITTER	\$2,627.84	\$2,954.55	\$403.88
43-3N-28-509A-0010-0000	KEVIN J & ANH N ROBERTS	\$2,627.84	\$2,954.55	\$403.88
43-3N-28-509C-0105-0000	GLENN M & LORI ANNE ROGERO	\$2,627.84	\$2,954.55	\$403.88
43-3N-28-509C-0067-0000	MARSHALL W & CAROL C ROWLAND	\$2,627.84	\$2,954.55	\$403.88
43-3N-28-509F-0023-0000	DANIEL O & PATRICIA A RYALS	\$2,627.84	\$2,954.55	\$403.88
43-3N-28-509C-0081-0000	WILLIAM A & PATRICIA A RYALS	\$2,627.84	\$2,954.55	\$403.88
43-3N-28-509C-0083-0000	WILLIAM A & PATRICIA A RYALS	\$2,627.84	\$2,954.55	\$403.88
43-3N-28-509C-0063-0000	ROBERT D & MARVILENE M SAGE	\$2,627.84	\$2,954.55	\$403.88
43-3N-28-509B-0031-0000	JAMES & KAREN L SALIS	\$2,627.84	\$2,954.55	\$403.88
43-3N-28-509C-0092-0000	GLADYS SANCHEZ	\$2,627.84	\$2,954.55	\$403.88
43-3N-28-509D-0008-0000	LAURIE J A SANDERSON	\$2,627.84	\$2,954.55	\$403.88
43-3N-28-509B-0053-0000	RAYMOND E & BENITA P SAPP	\$2,627.84	\$2,954.55	\$403.88

<b>Parcel ID</b>	<b>Owner Name</b>	<b>Initial Prepayment</b>	<b>Adjusted Prepayment</b>	<b>Annual Assessment</b>
43-3N-28-509A-0012-0000	RICHARD A & SANDRA R SAUL	\$2,627.84	\$2,954.55	\$403.88
43-3N-28-509C-0078-0000	WILLIAM & CONSTANCE SCHNIPPERT	\$5,255.69	\$5,909.11	\$807.75
43-3N-28-509B-0061-0000	JONATHAN SELTZ	\$2,627.84	\$2,954.55	\$403.88
43-3N-28-509B-0017-0000	VENELDA V SERGENT	\$2,627.84	\$2,954.55	\$403.88
43-3N-28-509C-0021-0000	RICHARD M SEYLER	\$2,627.84	\$2,954.55	\$403.88
43-3N-28-509B-0059-0000	DAVID & JENNIFER P SIRMANS	\$2,627.84	\$2,954.55	\$403.88
43-3N-28-509B-0010-0000	MARVIN N JR & PATRICIA SMITH	\$2,627.84	\$2,954.55	\$403.88
43-3N-28-509G-0006-0000	MARY K & KENNETH SNYDER	\$2,627.84	\$2,954.55	\$403.88
43-3N-28-509C-0019-0000	DWIGHT L & MARLA D SOUTHWELL	\$2,627.84	\$2,954.55	\$403.88
43-3N-28-509B-0011-0000	LONNIE R & NANCY H STALCUP	\$2,627.84	\$2,954.55	\$403.88
43-3N-28-509C-0084-0000	WAYNE R & BEVERLY G STELLMACH	\$2,627.84	\$2,954.55	\$403.88
43-3N-28-509B-0038-0000	BOBBY T & ANN MARIE STEVISON	\$2,627.84	\$2,954.55	\$403.88
43-3N-28-509A-0061-0000	ALBERT A & PHYLLIS M STODDARD	\$2,627.84	\$2,954.55	\$403.88
43-3N-28-509C-0027-0000	NIELSON D & LORRAINE T STRONG	\$2,627.84	\$2,954.55	\$403.88
43-3N-28-509C-0005-0000	GERALD W & PENNY I SUGGS	\$2,627.84	\$2,954.55	\$403.88
43-3N-28-509C-0037-0000	HARI & USHA SURAPANENI	\$2,627.84	\$2,954.55	\$403.88
43-3N-28-509B-0042-0000	JOHN M & DELLA M SWANGER	\$2,627.84	\$2,954.55	\$403.88
43-3N-28-509B-0043-0000	JOHN M & DELLA M SWANGER	\$2,627.84	\$2,954.55	\$403.88
43-3N-28-509B-0051-0000	GEORGE M & MERLE V SWEAT	\$2,627.84	\$2,954.55	\$403.88
43-3N-28-509B-0012-0000	LILLIAN G TAUSCHER	\$2,627.84	\$2,954.55	\$403.88
43-3N-28-509D-0041-0000	DANIEL B TERRY	\$2,627.84	\$2,954.55	\$403.88
43-3N-28-509B-0024-0000	ROBERT & JUDIE TERRY	\$5,255.69	\$5,909.11	\$807.75
43-3N-28-509C-0095-0000	GARY THRIFT	\$2,627.84	\$2,954.55	\$403.88
43-3N-28-509C-0096-0000	GARY B THRIFT	\$2,627.84	\$2,954.55	\$403.88
43-3N-28-509E-0018-0000	SUSAN P TILIAKOS	\$2,627.84	\$2,954.55	\$403.88
43-3N-28-509C-0091-0000	CHARLES S JR & BETTY J TOLIVER	\$2,627.84	\$2,954.55	\$403.88
43-3N-28-509D-0038-0000	JULIE P TOMLINSON	\$2,627.84	\$2,954.55	\$403.88
43-3N-28-509A-0062-0000	RONALD D & MARY W TROW	\$2,627.84	\$2,954.55	\$403.88
43-3N-28-509F-0006-0000	DAVID L TURNER	\$2,627.84	\$2,954.55	\$403.88
43-3N-28-509F-0007-0000	DAVID L TURNER	\$2,627.84	\$2,954.55	\$403.88
43-3N-28-509F-0018-0000	DAVID L TURNER	\$2,627.84	\$2,954.55	\$403.88
43-3N-28-509B-0049-0000	WILLIAM L & MARY F USSERY	\$2,627.84	\$2,954.55	\$403.88
43-3N-28-509B-0019-0000	ALSTYNE ROBERT T & MARY E VAN	\$2,627.84	\$2,954.55	\$403.88
43-3N-28-509B-0046-0000	WILLIE W JR & DEBRA A WALKER	\$2,627.84	\$2,954.55	\$403.88
43-3N-28-509A-0059-0000	JAMES H WARREN	\$2,627.84	\$2,954.55	\$403.88

<b>Parcel ID</b>	<b>Owner Name</b>	<b>Initial Prepayment</b>	<b>Adjusted Prepayment</b>	<b>Annual Assessment</b>
43-3N-28-509C-0030-0000	JAMES P & ROZLYN C WARREN	\$2,627.84	\$2,954.55	\$403.88
43-3N-28-509A-0033-0000	STEPHEN D WARREN	\$2,627.84	\$2,954.55	\$403.88
43-3N-28-509D-0052-0000	HARVEY K & ADRIANNE T WATSON	\$2,627.84	\$2,954.55	\$403.88
43-3N-28-509C-0059-0000	JACK D & SHARON M WATSON	\$2,627.84	\$2,954.55	\$403.88
43-3N-28-509D-0049-0000	JACKY F & WANDA SUE WATSON	\$2,627.84	\$2,954.55	\$403.88
43-3N-28-509B-0035-0000	HELEN A SMITH WEAVER	\$2,627.84	\$2,954.55	\$403.88
43-3N-28-509D-0050-0000	JULIANA WRIGHT WEEKS	\$2,627.84	\$2,954.55	\$403.88
43-3N-28-509A-0036-0000	JOSEPH N WEHBY	\$2,627.84	\$2,954.55	\$403.88
43-3N-28-509A-0016-0000	GENE W & JUNE L WELLS	\$2,627.84	\$2,954.55	\$403.88
43-3N-28-509A-0017-0000	GENE W & JUNE L WELLS	\$2,627.84	\$2,954.55	\$403.88
43-3N-28-509A-0020-0000	BEVERLY M WHITE	\$2,627.84	\$2,954.55	\$403.88
43-3N-28-509A-0008-0000	JOYCE WARE WHITE	\$2,627.84	\$2,954.55	\$403.88
43-3N-28-509B-0057-0000	ALLAN K WILLIAMS	\$2,627.84	\$2,954.55	\$403.88
43-3N-28-509B-0058-0000	ALLAN K WILLIAMS	\$2,627.84	\$2,954.55	\$403.88
43-3N-28-509C-0061-0000	ROBIN R WILLIS	\$2,627.84	\$2,954.55	\$403.88
43-3N-28-509F-0015-0000	PAUL C JR & EATHA MAE WILSON	\$2,627.84	\$2,954.55	\$403.88
43-3N-28-509A-0004-0000	KENNY C K & LORETTA WONG	\$2,627.84	\$2,954.55	\$403.88
43-3N-28-509G-0005-0000	KERRY S WOODS	\$2,627.84	\$2,954.55	\$403.88
43-3N-28-509B-0027-0000	WILLIAM B & EDITH W WORD	\$2,627.84	\$2,954.55	\$403.88
43-3N-28-509B-0009-0000	SILAS W & WANDA T WORTH	\$2,627.84	\$2,954.55	\$403.88
43-3N-28-509C-0039-0000	KURT D & LERA L WULLENWEBER	\$2,627.84	\$2,954.55	\$403.88
43-3N-28-509D-0066-0000	VICTOR F & MARY C YATES	\$2,627.84	\$2,954.55	\$403.88
43-3N-28-509D-0002-0000	VERNON W & JOAN A ZACHOW	\$5,255.69	\$5,909.11	\$807.75
43-3N-28-509C-0033-0000	EDWARD A & MARY H ZACK	\$2,627.84	\$2,954.55	\$403.88
<b>Total Parcels: 334</b>		<b>\$924,999.85</b>	<b>\$1,040,001.76</b>	<b>\$142,165.58</b>

# Pirates Wood

## Fiscal Year 2001-2002 Assessment

<b>Parcel ID</b>	<b>Owner Name</b>	<b>Initial Prepayment</b>	<b>Adjusted Prepayment</b>	<b>Annual Assessment</b>
43-3N-28-509A-0001-0000	GRADY S JR & JOANN MAULDIN	\$5,255.69	\$5,909.11	\$807.75
43-3N-28-509A-0003-0000	D L & BETTY JOHN	\$2,627.84	\$2,954.55	\$403.88
43-3N-28-509A-0004-0000	KENNY C K & LORETTA WONG	\$2,627.84	\$2,954.55	\$403.88
43-3N-28-509A-0005-0000	CAROL B MULLER	\$2,627.84	\$2,954.55	\$403.88
43-3N-28-509A-0006-0000	MIRIAM MOONEY BEBERMAN	\$2,627.84	\$2,954.55	\$403.88
43-3N-28-509A-0007-0000	INGRID S HEINEMANN	\$2,627.84	\$2,954.55	\$403.88
43-3N-28-509A-0008-0000	JOYCE WARE WHITE	\$2,627.84	\$2,954.55	\$403.88
43-3N-28-509A-0009-0000	FRANKIE J NAIL	\$2,627.84	\$2,954.55	\$403.88
43-3N-28-509A-0010-0000	KEVIN J & ANH N ROBERTS	\$2,627.84	\$2,954.55	\$403.88
43-3N-28-509A-0011-0000	CHRISTOPHER S NELSON	\$2,627.84	\$2,954.55	\$403.88
43-3N-28-509A-0012-0000	RICHARD A & SANDRA R SAUL	\$2,627.84	\$2,954.55	\$403.88
43-3N-28-509A-0013-0000	ALBERT F NELSON	\$2,627.84	\$2,954.55	\$403.88
43-3N-28-509A-0014-0000	WADE RAULERSON	\$2,627.84	\$2,954.55	\$403.88
43-3N-28-509A-0015-0000	RICHARD R GERMANO	\$2,627.84	\$2,954.55	\$403.88
43-3N-28-509A-0016-0000	GENE W & JUNE L WELLS	\$2,627.84	\$2,954.55	\$403.88
43-3N-28-509A-0017-0000	GENE W & JUNE L WELLS	\$2,627.84	\$2,954.55	\$403.88
43-3N-28-509A-0018-0000	WILLIAM J MONROE	\$2,627.84	\$2,954.55	\$403.88
43-3N-28-509A-0019-0000	KENNIE E BRADDOCK	\$2,627.84	\$2,954.55	\$403.88
43-3N-28-509A-0020-0000	BEVERLY M WHITE	\$2,627.84	\$2,954.55	\$403.88
43-3N-28-509A-0022-0000	KENNIE E BRADDOCK	\$2,627.84	\$2,954.55	\$403.88
43-3N-28-509A-0023-0000	BETTY S EGAN	\$2,627.84	\$2,954.55	\$403.88
43-3N-28-509A-0024-0000	CARMA ROBINSON KERN	\$2,627.84	\$2,954.55	\$403.88
43-3N-28-509A-0025-0000	WARREN & LORETTA PEEPLES	\$2,627.84	\$2,954.55	\$403.88
43-3N-28-509A-0027-0000	WARREN & LORETTA PEEPLES	\$2,627.84	\$2,954.55	\$403.88
43-3N-28-509A-0028-0000	TRAVIS J & FANNIE M CARTER	\$2,627.84	\$2,954.55	\$403.88
43-3N-28-509A-0029-0000	DONALD & JACKIE R BAKER	\$2,627.84	\$2,954.55	\$403.88
43-3N-28-509A-0030-0000	JEFFREY D & CYNTHIA C HUGHES	\$2,627.84	\$2,954.55	\$403.88
43-3N-28-509A-0031-0000	KAREN R CLACK	\$2,627.84	\$2,954.55	\$403.88
43-3N-28-509A-0032-0000	BARRY B & DANIELLE G MCKENDREE	\$2,627.84	\$2,954.55	\$403.88
43-3N-28-509A-0033-0000	STEPHEN D WARREN	\$2,627.84	\$2,954.55	\$403.88



<b>Parcel ID</b>	<b>Owner Name</b>	<b>Initial Prepayment</b>	<b>Adjusted Prepayment</b>	<b>Annual Assessment</b>
43-3N-28-509A-0034-0000	RICHARD E JR & BETHEL L BOLTON	\$2,627.84	\$2,954.55	\$403.88
43-3N-28-509A-0035-0000	BETHEL L BOLTON	\$2,627.84	\$2,954.55	\$403.88
43-3N-28-509A-0036-0000	JOSEPH N WEHBY	\$2,627.84	\$2,954.55	\$403.88
43-3N-28-509A-0037-0000	MARY K BROWN	\$2,627.84	\$2,954.55	\$403.88
43-3N-28-509A-0039-0000	WALTER JR & TONYA ELIUM	\$2,627.84	\$2,954.55	\$403.88
43-3N-28-509A-0040-0000	WALTER D JR & TONYA H ELIUM	\$2,627.84	\$2,954.55	\$403.88
43-3N-28-509A-0041-0000	THOMAS & LORI ANN CENICOLA	\$2,627.84	\$2,954.55	\$403.88
43-3N-28-509A-0042-0000	ROBERT B NEVIN	\$2,627.84	\$2,954.55	\$403.88
43-3N-28-509A-0043-0000	THOMAS D & JACLYN J GUY	\$2,627.84	\$2,954.55	\$403.88
43-3N-28-509A-0044-0000	MARK & MARY M MINOTIS	\$2,627.84	\$2,954.55	\$403.88
43-3N-28-509A-0045-0000	VALERIE D NICHOLS	\$2,627.84	\$2,954.55	\$403.88
43-3N-28-509A-0046-0000	EDMOND F & PEGGY C BIERLEY	\$2,627.84	\$2,954.55	\$403.88
43-3N-28-509A-0047-0000	WILLIAM & RUTH CHICHEKIAN	\$2,627.84	\$2,954.55	\$403.88
43-3N-28-509A-0048-0000	JOHN N & JOAN G ITAK	\$2,627.84	\$2,954.55	\$403.88
43-3N-28-509A-0049-0000	GERALDINE DOPSON	\$2,627.84	\$2,954.55	\$403.88
43-3N-28-509A-0050-0000	RICK EDWARD DOPSON	\$2,627.84	\$2,954.55	\$403.88
43-3N-28-509A-0051-0000	WILLIAM LIGHTFOOT	\$2,627.84	\$2,954.55	\$403.88
43-3N-28-509A-0052-0000	LINDA WOOD	\$2,627.84	\$2,954.55	\$403.88
43-3N-28-509A-0053-0000	JOHN L & PATSY BUNCH	\$2,627.84	\$2,954.55	\$403.88
43-3N-28-509A-0054-0000	HARRY HUGHES	\$2,627.84	\$2,954.55	\$403.88
43-3N-28-509A-0055-0000	HARRY HUGHES	\$2,627.84	\$2,954.55	\$403.88
43-3N-28-509A-0056-0000	HARRY HUGHES	\$2,627.84	\$2,954.55	\$403.88
43-3N-28-509A-0057-0000	JAMES EVERETT & SUSAN W DAVIS	\$2,627.84	\$2,954.55	\$403.88
43-3N-28-509A-0058-0000	LARRY D & PEGGY H KENDRICK	\$2,627.84	\$2,954.55	\$403.88
43-3N-28-509A-0059-0000	JAMES H WARREN	\$2,627.84	\$2,954.55	\$403.88
43-3N-28-509A-0060-0000	RICHARD R GERMANO	\$2,627.84	\$2,954.55	\$403.88
43-3N-28-509A-0061-0000	ALBERT A & PHYLLIS M STODDARD	\$2,627.84	\$2,954.55	\$403.88
43-3N-28-509A-0062-0000	RONALD D & MARY W TROW	\$2,627.84	\$2,954.55	\$403.88
43-3N-28-509A-0063-0000	LAWRENCE R MOBLEY	\$2,627.84	\$2,954.55	\$403.88
43-3N-28-509A-0064-0000	WILLIAM J SR MONROE	\$2,627.84	\$2,954.55	\$403.88
43-3N-28-509A-0065-0000	WILLIAM J SR MONROE	\$2,627.84	\$2,954.55	\$403.88
43-3N-28-509A-0066-0000	GARY & BEVERLY KNAPPENBERGER	\$2,627.84	\$2,954.55	\$403.88
43-3N-28-509A-0067-0000	GARY & BEVERLY KNAPPENBERGER	\$2,627.84	\$2,954.55	\$403.88
43-3N-28-509A-0068-0000	GARY & BEVERLY KNAPPENBERGER	\$2,627.84	\$2,954.55	\$403.88
43-3N-28-509B-0001-0000	MICHEAL R & PHYLLIS H NADEAU	\$2,627.84	\$2,954.55	\$403.88

<b>Parcel ID</b>	<b>Owner Name</b>	<b>Initial Prepayment</b>	<b>Adjusted Prepayment</b>	<b>Annual Assessment</b>
43-3N-28-509B-0002-0000	RICHARD L & KRISTI D GOAR	\$2,627.84	\$2,954.55	\$403.88
43-3N-28-509B-0003-0000	PATRICK A & SARAH K MALEY	\$2,627.84	\$2,954.55	\$403.88
43-3N-28-509B-0004-0000	MATTHEW GRIFFIN	\$5,255.69	\$5,909.11	\$807.75
43-3N-28-509B-0006-0000	JULIE M PILLSBURY	\$2,627.84	\$2,954.55	\$403.88
43-3N-28-509B-0007-0000	EARLE C III & LISA B HULETT	\$2,627.84	\$2,954.55	\$403.88
43-3N-28-509B-0008-0000	EARLE C III & LISA B HULETT	\$2,627.84	\$2,954.55	\$403.88
43-3N-28-509B-0009-0000	SILAS W & WANDA T WORTH	\$2,627.84	\$2,954.55	\$403.88
43-3N-28-509B-0010-0000	MARVIN N JR & PATRICIA SMITH	\$2,627.84	\$2,954.55	\$403.88
43-3N-28-509B-0011-0000	LONNIE R & NANCY H STALCUP	\$2,627.84	\$2,954.55	\$403.88
43-3N-28-509B-0012-0000	LILLIAN G TAUSCHER	\$2,627.84	\$2,954.55	\$403.88
43-3N-28-509B-0014-0000	SARAH E POPE	\$2,627.84	\$2,954.55	\$403.88
43-3N-28-509B-0015-0000	TOMMY E & TAMMY R ANDERSON	\$2,627.84	\$2,954.55	\$403.88
43-3N-28-509B-0016-0000	WILLIAM & RUTH CHICHEKIAN	\$2,627.84	\$2,954.55	\$403.88
43-3N-28-509B-0017-0000	VENELDA V SERGENT	\$2,627.84	\$2,954.55	\$403.88
43-3N-28-509B-0018-0000	JOHN D & ALMA D PRUITT	\$2,627.84	\$2,954.55	\$403.88
43-3N-28-509B-0019-0000	ALSTYNE ROBERT T & MARY E VAN	\$2,627.84	\$2,954.55	\$403.88
43-3N-28-509B-0020-0000	DALE L AUCK	\$2,627.84	\$2,954.55	\$403.88
43-3N-28-509B-0021-0000	MAULDIN-COTTRELL INC	\$2,627.84	\$2,954.55	\$403.88
43-3N-28-509B-0022-0000	MAULDIN-COTTRELL INC	\$2,627.84	\$2,954.55	\$403.88
43-3N-28-509B-0023-0000	MAULDIN-COTTRELL INC	\$2,627.84	\$2,954.55	\$403.88
43-3N-28-509B-0024-0000	ROBERT & JUDIE TERRY	\$5,255.69	\$5,909.11	\$807.75
43-3N-28-509B-0026-0000	MATTHEW & TARA T HIGGINBOTHAM	\$2,627.84	\$2,954.55	\$403.88
43-3N-28-509B-0027-0000	WILLIAM B & EDITH W WORD	\$2,627.84	\$2,954.55	\$403.88
43-3N-28-509B-0028-0000	EDYTH HUBBARD	\$2,627.84	\$2,954.55	\$403.88
43-3N-28-509B-0029-0000	MIRIAM E BEBERMAN	\$2,627.84	\$2,954.55	\$403.88
43-3N-28-509B-0030-0000	JIM & DANNA CHATWELL	\$2,627.84	\$2,954.55	\$403.88
43-3N-28-509B-0031-0000	JAMES & KAREN L SALIS	\$2,627.84	\$2,954.55	\$403.88
43-3N-28-509B-0032-0000	LOUIS R GRIFFIN	\$2,627.84	\$2,954.55	\$403.88
43-3N-28-509B-0033-0000	HERBERT M & ROSALITTA W GRAHAM	\$2,627.84	\$2,954.55	\$403.88
43-3N-28-509B-0034-0000	ANTHONY LEE FISHER	\$2,627.84	\$2,954.55	\$403.88
43-3N-28-509B-0035-0000	HELEN A SMITH WEAVER	\$2,627.84	\$2,954.55	\$403.88
43-3N-28-509B-0036-0000	ROBERT & DELORES RATHBONE	\$2,627.84	\$2,954.55	\$403.88
43-3N-28-509B-0037-0000	RICHARD L & KRISTI D GOAR	\$2,627.84	\$2,954.55	\$403.88
43-3N-28-509B-0038-0000	BOBBY T & ANN MARIE STEVISON	\$2,627.84	\$2,954.55	\$403.88
43-3N-28-509B-0039-0000	PATRICK DUNLAP	\$2,627.84	\$2,954.55	\$403.88

<b>Parcel ID</b>	<b>Owner Name</b>	<b>Initial Prepayment</b>	<b>Adjusted Prepayment</b>	<b>Annual Assessment</b>
43-3N-28-509B-0040-0000	MAULDIN-COTTRELL INC	\$2,627.84	\$2,954.55	\$403.88
43-3N-28-509B-0041-0000	MAULDIN-COTTRELL INC	\$2,627.84	\$2,954.55	\$403.88
43-3N-28-509B-0042-0000	JOHN M & DELLA M SWANGER	\$2,627.84	\$2,954.55	\$403.88
43-3N-28-509B-0043-0000	JOHN M & DELLA M SWANGER	\$2,627.84	\$2,954.55	\$403.88
43-3N-28-509B-0044-0000	MAULDIN-COTTRELL INC	\$2,627.84	\$2,954.55	\$403.88
43-3N-28-509B-0045-0000	MAULDIN-COTTRELL INC	\$2,627.84	\$2,954.55	\$403.88
43-3N-28-509B-0046-0000	WILLIE W JR & DEBRA A WALKER	\$2,627.84	\$2,954.55	\$403.88
43-3N-28-509B-0047-0000	J J & J P O'CONNER	\$2,627.84	\$2,954.55	\$403.88
43-3N-28-509B-0048-0000	ROBERT & TERRY GRIFFIN	\$2,627.84	\$2,954.55	\$403.88
43-3N-28-509B-0049-0000	WILLIAM L & MARY F USSERY	\$2,627.84	\$2,954.55	\$403.88
43-3N-28-509B-0050-0000	MAULDIN-COTTRELL INC	\$2,627.84	\$2,954.55	\$403.88
43-3N-28-509B-0051-0000	GEORGE M & MERLE V SWEAT	\$2,627.84	\$2,954.55	\$403.88
43-3N-28-509B-0052-0000	KIRBY L & JANICE A HENDRIX	\$2,627.84	\$2,954.55	\$403.88
43-3N-28-509B-0053-0000	RAYMOND E & BENITA P SAPP	\$2,627.84	\$2,954.55	\$403.88
43-3N-28-509B-0054-0000	FRANK J & DIANE E CAMAROTTI	\$2,627.84	\$2,954.55	\$403.88
43-3N-28-509B-0055-0000	JAMES A III CORBETT	\$2,627.84	\$2,954.55	\$403.88
43-3N-28-509B-0056-0000	CAREY O & CAROLYN Y LYNCKER	\$2,627.84	\$2,954.55	\$403.88
43-3N-28-509B-0057-0000	ALLAN K WILLIAMS	\$2,627.84	\$2,954.55	\$403.88
43-3N-28-509B-0058-0000	ALLAN K WILLIAMS	\$2,627.84	\$2,954.55	\$403.88
43-3N-28-509B-0059-0000	DAVID & JENNIFER P SIRMANS	\$2,627.84	\$2,954.55	\$403.88
43-3N-28-509B-0060-0000	JOHN T & JANET L MCMAHAN	\$2,627.84	\$2,954.55	\$403.88
43-3N-28-509B-0061-0000	JONATHAN SELTZ	\$2,627.84	\$2,954.55	\$403.88
43-3N-28-509B-0062-0000	JOHN T JR & JANET L MCMAHAN	\$2,627.84	\$2,954.55	\$403.88
43-3N-28-509B-0063-0000	DAVID KEITH COTTRELL	\$2,627.84	\$2,954.55	\$403.88
43-3N-28-509C-0001-0000	GORDON & CAROL E PHILLIPS	\$2,627.84	\$2,954.55	\$403.88
43-3N-28-509C-0002-0000	DENNIS KAPPARIS	\$2,627.84	\$2,954.55	\$403.88
43-3N-28-509C-0003-0000	WILLIAM IRB BENNETT	\$2,627.84	\$2,954.55	\$403.88
43-3N-28-509C-0004-0000	MARIE R ESTES	\$2,627.84	\$2,954.55	\$403.88
43-3N-28-509C-0005-0000	GERALD W & PENNY I SUGGS	\$2,627.84	\$2,954.55	\$403.88
43-3N-28-509C-0006-0000	MAULDIN-COTTRELL INC	\$2,627.84	\$2,954.55	\$403.88
43-3N-28-509C-0007-0000	MAULDIN-COTTRELL INC	\$2,627.84	\$2,954.55	\$403.88
43-3N-28-509C-0008-0000	MAULDIN-COTTRELL INC	\$2,627.84	\$2,954.55	\$403.88
43-3N-28-509C-0009-0000	DONNA MARIE TOMKA BASS	\$2,627.84	\$2,954.55	\$403.88
43-3N-28-509C-0010-0000	ROBERT E & HAZEL E BRIGGS	\$2,627.84	\$2,954.55	\$403.88
43-3N-28-509C-0011-0000	ROBERT E & HAZEL E BRIGGS	\$2,627.84	\$2,954.55	\$403.88

<b>Parcel ID</b>	<b>Owner Name</b>	<b>Initial Prepayment</b>	<b>Adjusted Prepayment</b>	<b>Annual Assessment</b>
43-3N-28-509C-0012-0000	W STANLEY & CYNTHIA A MILES	\$2,627.84	\$2,954.55	\$403.88
43-3N-28-509C-0013-0000	HERBERT & MERRIMAE C MCFADDEN	\$2,627.84	\$2,954.55	\$403.88
43-3N-28-509C-0014-0000	ROBERT F BULOW	\$2,627.84	\$2,954.55	\$403.88
43-3N-28-509C-0015-0000	MARK C & LISA K PFIESTER	\$2,627.84	\$2,954.55	\$403.88
43-3N-28-509C-0016-0000	NORMAN K & MARJORIE H LUCIO	\$2,627.84	\$2,954.55	\$403.88
43-3N-28-509C-0017-0000	LARRY D & HOPE S DUGGAN	\$2,627.84	\$2,954.55	\$403.88
43-3N-28-509C-0018-0000	TRAVIS L & MICHELE CHAIRES	\$2,627.84	\$2,954.55	\$403.88
43-3N-28-509C-0019-0000	DWIGHT L & MARLA D SOUTHWELL	\$2,627.84	\$2,954.55	\$403.88
43-3N-28-509C-0020-0000	DAVID K & MARY ELLEN CORBIN	\$2,627.84	\$2,954.55	\$403.88
43-3N-28-509C-0021-0000	RICHARD M SEYLER	\$2,627.84	\$2,954.55	\$403.88
43-3N-28-509C-0022-0000	ORTRUD D FORSTER	\$2,627.84	\$2,954.55	\$403.88
43-3N-28-509C-0023-0000	DEAN BLAKE	\$2,627.84	\$2,954.55	\$403.88
43-3N-28-509C-0024-0000	DEAN BLAKE	\$2,627.84	\$2,954.55	\$403.88
43-3N-28-509C-0025-0000	DEAN BLAKE	\$5,255.69	\$5,909.11	\$807.75
43-3N-28-509C-0027-0000	NIELSON D & LORRAINE T STRONG	\$2,627.84	\$2,954.55	\$403.88
43-3N-28-509C-0028-0000	CHRISTOPHER T & RHONDA L BLAKE	\$2,627.84	\$2,954.55	\$403.88
43-3N-28-509C-0029-0000	CHRISTOPHER T & RHONDA L BLAKE	\$2,627.84	\$2,954.55	\$403.88
43-3N-28-509C-0030-0000	JAMES P & ROZLYN C WARREN	\$2,627.84	\$2,954.55	\$403.88
43-3N-28-509C-0031-0000	ROBERT BRENCE & RAYE M PECK	\$2,627.84	\$2,954.55	\$403.88
43-3N-28-509C-0032-0000	RUSSELL C & JOYCE F BOWMAN	\$2,627.84	\$2,954.55	\$403.88
43-3N-28-509C-0033-0000	EDWARD A & MARY H ZACK	\$2,627.84	\$2,954.55	\$403.88
43-3N-28-509C-0034-0000	JOHN DARRELL LONG	\$5,255.69	\$5,909.11	\$807.75
43-3N-28-509C-0036-0000	RICHARD S & CAROLYN S RITTER	\$2,627.84	\$2,954.55	\$403.88
43-3N-28-509C-0037-0000	HARI & USHA SURAPANENI	\$2,627.84	\$2,954.55	\$403.88
43-3N-28-509C-0038-0000	HARRINGTON & CAROLINE MORRISON	\$2,627.84	\$2,954.55	\$403.88
43-3N-28-509C-0039-0000	KURT D & LERA L WULLENWEBER	\$2,627.84	\$2,954.55	\$403.88
43-3N-28-509C-0040-0000	AMANDA C JUBITO	\$2,627.84	\$2,954.55	\$403.88
43-3N-28-509C-0041-0000	RAYMOND G & J A PHILLIPS	\$2,627.84	\$2,954.55	\$403.88
43-3N-28-509C-0042-0000	SHIRLEY A POTEAT	\$2,627.84	\$2,954.55	\$403.88
43-3N-28-509C-0043-0000	SHIRLEY A POTEAT	\$2,627.84	\$2,954.55	\$403.88
43-3N-28-509C-0044-0000	SHIRLEY A POTEAT	\$2,627.84	\$2,954.55	\$403.88
43-3N-28-509C-0045-0000	JACK K CURTRIGHT	\$2,627.84	\$2,954.55	\$403.88
43-3N-28-509C-0046-0000	WARREN & LORETTA PEEPLES	\$2,627.84	\$2,954.55	\$403.88
43-3N-28-509C-0047-0000	WARREN & LORETTA PEEPLES	\$2,627.84	\$2,954.55	\$403.88
43-3N-28-509C-0048-0000	SHARON J REIN	\$5,255.69	\$5,909.11	\$807.75

<b>Parcel ID</b>	<b>Owner Name</b>	<b>Initial Prepayment</b>	<b>Adjusted Prepayment</b>	<b>Annual Assessment</b>
43-3N-28-509C-0050-0000	MARK A & KIM E KOSSAKOWSKI	\$2,627.84	\$2,954.55	\$403.88
43-3N-28-509C-0051-0000	JENNIFER ANN GREESON	\$2,627.84	\$2,954.55	\$403.88
43-3N-28-509C-0052-0000	DONNELL L MOBLEY	\$5,255.69	\$5,909.11	\$807.75
43-3N-28-509C-0054-0000	JACQUELINE M HARDING	\$2,627.84	\$2,954.55	\$403.88
43-3N-28-509C-0055-0000	DAVID W & SANDRA R FRAZIER	\$2,627.84	\$2,954.55	\$403.88
43-3N-28-509C-0056-0000	PATRICK CARROLL	\$2,627.84	\$2,954.55	\$403.88
43-3N-28-509C-0057-0000	PATRICK CARROLL	\$2,627.84	\$2,954.55	\$403.88
43-3N-28-509C-0058-0000	JAMES R III & BARBARA A PARKER	\$2,627.84	\$2,954.55	\$403.88
43-3N-28-509C-0059-0000	JACK D & SHARON M WATSON	\$2,627.84	\$2,954.55	\$403.88
43-3N-28-509C-0060-0000	JEFFREY EWALD HEAD	\$2,627.84	\$2,954.55	\$403.88
43-3N-28-509C-0061-0000	ROBIN R WILLIS	\$2,627.84	\$2,954.55	\$403.88
43-3N-28-509C-0062-0000	CHRISTINE C & STEVEN G MURRAY	\$2,627.84	\$2,954.55	\$403.88
43-3N-28-509C-0063-0000	ROBERT D & MARVILENE M SAGE	\$2,627.84	\$2,954.55	\$403.88
43-3N-28-509C-0064-0000	JEAN R MILES	\$2,627.84	\$2,954.55	\$403.88
43-3N-28-509C-0065-0000	MARK F & DONNA L GRIFFIN	\$2,627.84	\$2,954.55	\$403.88
43-3N-28-509C-0066-0000	BRUCE B & SHERRIE L NELSON	\$2,627.84	\$2,954.55	\$403.88
43-3N-28-509C-0067-0000	MARSHALL W & CAROL C ROWLAND	\$2,627.84	\$2,954.55	\$403.88
43-3N-28-509C-0068-0000	MAULDIN-COTTRELL INC	\$2,627.84	\$2,954.55	\$403.88
43-3N-28-509C-0069-0000	MAULDIN-COTTRELL INC	\$2,627.84	\$2,954.55	\$403.88
43-3N-28-509C-0070-0000	MAULDIN-COTTRELL INC	\$2,627.84	\$2,954.55	\$403.88
43-3N-28-509C-0071-0000	MAULDIN-COTTRELL INC	\$2,627.84	\$2,954.55	\$403.88
43-3N-28-509C-0072-0000	MICHAEL K & TERESA KENNEDY	\$2,627.84	\$2,954.55	\$403.88
43-3N-28-509C-0073-0000	PAUL D ALEXANDER	\$2,627.84	\$2,954.55	\$403.88
43-3N-28-509C-0074-0000	JOHN A FOX	\$2,627.84	\$2,954.55	\$403.88
43-3N-28-509C-0075-0000	PETER F & CHRISTINE M CHAPMAN	\$2,627.84	\$2,954.55	\$403.88
43-3N-28-509C-0076-0000	THOMAS N & MARGARET APPLEWHITE	\$2,627.84	\$2,954.55	\$403.88
43-3N-28-509C-0078-0000	WILLIAM & CONSTANCE SCHNIPPERT	\$5,255.69	\$5,909.11	\$807.75
43-3N-28-509C-0081-0000	WILLIAM A & PATRICIA A RYALS	\$2,627.84	\$2,954.55	\$403.88
43-3N-28-509C-0083-0000	WILLIAM A & PATRICIA A RYALS	\$2,627.84	\$2,954.55	\$403.88
43-3N-28-509C-0084-0000	WAYNE R & BEVERLY G STELLMACH	\$2,627.84	\$2,954.55	\$403.88
43-3N-28-509C-0085-0000	MARK DAVID CORBIN	\$2,627.84	\$2,954.55	\$403.88
43-3N-28-509C-0086-0000	DOUGLAS P DEMASI	\$2,627.84	\$2,954.55	\$403.88
43-3N-28-509C-0087-0000	JOHN & HONI BEA MATHEWS	\$2,627.84	\$2,954.55	\$403.88
43-3N-28-509C-0088-0000	ALLAN D FULLARD	\$2,627.84	\$2,954.55	\$403.88
43-3N-28-509C-0089-0000	JAMES B CATRON	\$5,255.69	\$5,909.11	\$807.75

<b>Parcel ID</b>	<b>Owner Name</b>	<b>Initial Prepayment</b>	<b>Adjusted Prepayment</b>	<b>Annual Assessment</b>
43-3N-28-509C-0091-0000	CHARLES S JR & BETTY J TOLIVER	\$2,627.84	\$2,954.55	\$403.88
43-3N-28-509C-0092-0000	GLADYS SANCHEZ	\$2,627.84	\$2,954.55	\$403.88
43-3N-28-509C-0093-0000	ROGER P & ALIENE C HURSEY	\$2,627.84	\$2,954.55	\$403.88
43-3N-28-509C-0094-0000	MAC PETTIT	\$2,627.84	\$2,954.55	\$403.88
43-3N-28-509C-0095-0000	GARY THRIFT	\$2,627.84	\$2,954.55	\$403.88
43-3N-28-509C-0096-0000	GARY B THRIFT	\$2,627.84	\$2,954.55	\$403.88
43-3N-28-509C-0097-0000	DOLORES M HOLMES	\$2,627.84	\$2,954.55	\$403.88
43-3N-28-509C-0098-0000	ANNETTE P MOBLEY	\$2,627.84	\$2,954.55	\$403.88
43-3N-28-509C-0099-0000	DEBORAH J BEASLEY	\$5,255.69	\$5,909.11	\$807.75
43-3N-28-509C-0101-0000	JOHN D ADAMS	\$5,255.69	\$5,909.11	\$807.75
43-3N-28-509C-0103-0000	MAULDIN-COTTRELL INC	\$2,627.84	\$2,954.55	\$403.88
43-3N-28-509C-0104-0000	PAUL L & SANDRA M MURRAY	\$2,627.84	\$2,954.55	\$403.88
43-3N-28-509C-0105-0000	GLENN M & LORI ANNE ROGERO	\$2,627.84	\$2,954.55	\$403.88
43-3N-28-509C-0106-0000	MAULDIN-COTTRELL INC	\$2,627.84	\$2,954.55	\$403.88
43-3N-28-509C-0107-0000	MAULDIN-COTTRELL INC	\$2,627.84	\$2,954.55	\$403.88
43-3N-28-509C-0108-0000	MAULDIN-COTTRELL INC	\$2,627.84	\$2,954.55	\$403.88
43-3N-28-509D-0001-0000	CHARLES & PATRICIA MOTT	\$2,627.84	\$2,954.55	\$403.88
43-3N-28-509D-0002-0000	VERNON W & JOAN A ZACHOW	\$5,255.69	\$5,909.11	\$807.75
43-3N-28-509D-0004-0000	JOHN L & VIVIAN L BROOKER	\$2,627.84	\$2,954.55	\$403.88
43-3N-28-509D-0005-0000	GEORGE C LAWRENCE	\$2,627.84	\$2,954.55	\$403.88
43-3N-28-509D-0006-0000	BELTON J & HIROKO LITTLEFIELD	\$2,627.84	\$2,954.55	\$403.88
43-3N-28-509D-0007-0000	CORRINE C NELSON	\$2,627.84	\$2,954.55	\$403.88
43-3N-28-509D-0008-0000	LAURIE J A SANDERSON	\$2,627.84	\$2,954.55	\$403.88
43-3N-28-509D-0009-0000	ROBERT DONALD & BARBARA M PECK	\$2,627.84	\$2,954.55	\$403.88
43-3N-28-509D-0010-0000	DAVID K & EDNA E FRASER	\$2,627.84	\$2,954.55	\$403.88
43-3N-28-509D-0011-0000	JOHNNIE T ENTER	\$2,627.84	\$2,954.55	\$403.88
43-3N-28-509D-0012-0000	EDWARD R & SALLY J KEES	\$2,627.84	\$2,954.55	\$403.88
43-3N-28-509D-0013-0000	ROBERT M & KIM R HARDING	\$2,627.84	\$2,954.55	\$403.88
43-3N-28-509D-0014-0000	JAMES H SR & SHIRLEY A LEAR	\$2,627.84	\$2,954.55	\$403.88
43-3N-28-509D-0015-0000	PETER L OLIVER	\$2,627.84	\$2,954.55	\$403.88
43-3N-28-509D-0016-0000	TERRANCE D & SHARON A HARMAN	\$2,627.84	\$2,954.55	\$403.88
43-3N-28-509D-0017-0000	R W & SANDRA A LIVINGSTON	\$2,627.84	\$2,954.55	\$403.88
43-3N-28-509D-0019-0000	GEORGE B & LINDA W BLAKE	\$5,255.69	\$5,909.11	\$807.75
43-3N-28-509D-0021-0000	M SUZANNE LANSDELL	\$2,627.84	\$2,954.55	\$403.88
43-3N-28-509D-0022-0000	CRAIG T & MAROLYN K HOLDER	\$2,627.84	\$2,954.55	\$403.88

<b>Parcel ID</b>	<b>Owner Name</b>	<b>Initial Prepayment</b>	<b>Adjusted Prepayment</b>	<b>Annual Assessment</b>
43-3N-28-509D-0023-0000	BARTON T & JEANNE M CLARK	\$2,627.84	\$2,954.55	\$403.88
43-3N-28-509D-0024-0000	RICHARD J & JANINE M BRUCE	\$2,627.84	\$2,954.55	\$403.88
43-3N-28-509D-0025-0000	JAMES M & TERESA L COMPANION	\$2,627.84	\$2,954.55	\$403.88
43-3N-28-509D-0026-0000	MARGUERITE R & JIMMY L COTTLE	\$2,627.84	\$2,954.55	\$403.88
43-3N-28-509D-0027-0000	JAMES R & JANICE G DAVIS	\$2,627.84	\$2,954.55	\$403.88
43-3N-28-509D-0028-0000	PETER L OLIVER	\$2,627.84	\$2,954.55	\$403.88
43-3N-28-509D-0029-0000	CHRISTOPHER T & RHONDA L BLAKE	\$2,627.84	\$2,954.55	\$403.88
43-3N-28-509D-0030-0000	CHRISTINE S NELSON	\$2,627.84	\$2,954.55	\$403.88
43-3N-28-509D-0031-0000	ROSA M ADAMS	\$2,627.84	\$2,954.55	\$403.88
43-3N-28-509D-0032-0000	LARRY W & PATRICIA L FOWLER	\$2,627.84	\$2,954.55	\$403.88
43-3N-28-509D-0033-0000	WILLIAM STEPHEN CAMPBELL	\$5,255.69	\$5,909.11	\$807.75
43-3N-28-509D-0035-0000	WARREN A & SHARON D DAVIS	\$2,627.84	\$2,954.55	\$403.88
43-3N-28-509D-0036-0000	WILLIAM F & CAROL L LONG	\$2,627.84	\$2,954.55	\$403.88
43-3N-28-509D-0038-0000	JULIE P TOMLINSON	\$2,627.84	\$2,954.55	\$403.88
43-3N-28-509D-0039-0000	LINDA R COURTENAY	\$5,255.69	\$5,909.11	\$807.75
43-3N-28-509D-0041-0000	DANIEL B TERRY	\$2,627.84	\$2,954.55	\$403.88
43-3N-28-509D-0042-0000	BRANDON & MARY BLACKMON	\$2,627.84	\$2,954.55	\$403.88
43-3N-28-509D-0043-0000	JOHN P & PAULA F JOHNSTON	\$2,627.84	\$2,954.55	\$403.88
43-3N-28-509D-0044-0000	FLOYD L & CHARLENE B LOHMAN	\$2,627.84	\$2,954.55	\$403.88
43-3N-28-509D-0046-0000	JOHN R & LANEY C HOPKINS	\$2,627.84	\$2,954.55	\$403.88
43-3N-28-509D-0047-0000	JAMES B CATRON	\$2,627.84	\$2,954.55	\$403.88
43-3N-28-509D-0048-0000	M ALENE DAVIS	\$2,627.84	\$2,954.55	\$403.88
43-3N-28-509D-0049-0000	JACKY F & WANDA SUE WATSON	\$2,627.84	\$2,954.55	\$403.88
43-3N-28-509D-0050-0000	JULIANA WRIGHT WEEKS	\$2,627.84	\$2,954.55	\$403.88
43-3N-28-509D-0051-0000	GEORGE R & T MARGARET REID	\$2,627.84	\$2,954.55	\$403.88
43-3N-28-509D-0052-0000	HARVEY K & ADRIANNE T WATSON	\$2,627.84	\$2,954.55	\$403.88
43-3N-28-509D-0053-0000	EVERETT E & DORINDA D BENTON	\$2,627.84	\$2,954.55	\$403.88
43-3N-28-509D-0054-0000	EVERETTE & RINDI BENTON	\$2,627.84	\$2,954.55	\$403.88
43-3N-28-509D-0055-0000	THOMAS D & JONI BRANAN	\$2,627.84	\$2,954.55	\$403.88
43-3N-28-509D-0056-0000	CHARLES R BRANAN	\$2,627.84	\$2,954.55	\$403.88
43-3N-28-509D-0057-0000	THOMAS J & BARBARA D BENNETT	\$2,627.84	\$2,954.55	\$403.88
43-3N-28-509D-0058-0000	THOMAS J & BARBARA D BENNETT	\$2,627.84	\$2,954.55	\$403.88
43-3N-28-509D-0059-0000	EDWARD B & JANET J MEADOWS	\$2,627.84	\$2,954.55	\$403.88
43-3N-28-509D-0061-0000	NANCY L JONES	\$5,255.69	\$5,909.11	\$807.75
43-3N-28-509D-0064-0000	J LAWSON JOHNSON	\$2,627.84	\$2,954.55	\$403.88

<b>Parcel ID</b>	<b>Owner Name</b>	<b>Initial Prepayment</b>	<b>Adjusted Prepayment</b>	<b>Annual Assessment</b>
43-3N-28-509D-0065-0000	CHARLIE M GREGORY	\$2,627.84	\$2,954.55	\$403.88
43-3N-28-509D-0066-0000	VICTOR F & MARY C YATES	\$2,627.84	\$2,954.55	\$403.88
43-3N-28-509D-0067-0000	ALMA F BERRYHILL	\$2,627.84	\$2,954.55	\$403.88
43-3N-28-509D-0068-0000	SHIRLEY A POTEAT	\$2,627.84	\$2,954.55	\$403.88
43-3N-28-509D-0069-0010	SHIRLEY A POTEAT	\$2,627.84	\$2,954.55	\$403.88
43-3N-28-509D-0069-0020	BENOIT N DEMERS	\$2,627.84	\$2,954.55	\$403.88
43-3N-28-509D-0071-0000	NEIL A NEVIN	\$2,627.84	\$2,954.55	\$403.88
43-3N-28-509D-0073-0000	ANDREW J & LEJENE ALLAN	\$2,627.84	\$2,954.55	\$403.88
43-3N-28-509D-0074-0000	KARIN A DOPSON	\$2,627.84	\$2,954.55	\$403.88
43-3N-28-509D-0075-0000	DAVID ALLEN DOUGLAS	\$2,627.84	\$2,954.55	\$403.88
43-3N-28-509E-0001-0000	HOMER L & CHARLOTTE P HUTTO	\$2,627.84	\$2,954.55	\$403.88
43-3N-28-509E-0002-0000	HOMER L & CHARLOTTE P HUTTO	\$2,627.84	\$2,954.55	\$403.88
43-3N-28-509E-0003-0000	HOMER L & CHARLOTTE P HUTTO	\$2,627.84	\$2,954.55	\$403.88
43-3N-28-509E-0004-0000	MAULDIN-COTTRELL INC	\$2,627.84	\$2,954.55	\$403.88
43-3N-28-509E-0005-0000	MAULDIN-COTTRELL INC	\$2,627.84	\$2,954.55	\$403.88
43-3N-28-509E-0006-0000	MAULDIN-COTTRELL INC	\$2,627.84	\$2,954.55	\$403.88
43-3N-28-509E-0007-0000	MAULDIN-COTTRELL INC	\$2,627.84	\$2,954.55	\$403.88
43-3N-28-509E-0008-0000	WM K BERGLUND	\$2,627.84	\$2,954.55	\$403.88
43-3N-28-509E-0009-0000	JAMES E & LINDA K CARTWRIGHT	\$2,627.84	\$2,954.55	\$403.88
43-3N-28-509E-0010-0000	BRUCE F & LINDA A FREEMAN	\$7,883.53	\$8,863.65	\$1,211.62
43-3N-28-509E-0013-0000	MAULDIN-COTTRELL INC	\$2,627.84	\$2,954.55	\$403.88
43-3N-28-509E-0014-0000	MAULDIN-COTTRELL INC	\$2,627.84	\$2,954.55	\$403.88
43-3N-28-509E-0015-0000	MAULDIN-COTTRELL INC	\$2,627.84	\$2,954.55	\$403.88
43-3N-28-509E-0016-0000	RAMON & DEBORAH ORTIZ	\$2,627.84	\$2,954.55	\$403.88
43-3N-28-509E-0017-0000	RAMON & DEBORAH ORTIZ	\$2,627.84	\$2,954.55	\$403.88
43-3N-28-509E-0018-0000	SUSAN P TILIAKOS	\$2,627.84	\$2,954.55	\$403.88
43-3N-28-509E-0019-0000	BRUCE C & WANDA BIERDS	\$2,627.84	\$2,954.55	\$403.88
43-3N-28-509F-0001-0000	ARMANEST W & PATSY J ENNIS	\$2,627.84	\$2,954.55	\$403.88
43-3N-28-509F-0002-0000	THE PACETTI GROUP, INC	\$2,627.84	\$2,954.55	\$403.88
43-3N-28-509F-0003-0000	CHAD LEE	\$2,627.84	\$2,954.55	\$403.88
43-3N-28-509F-0004-0000	MAULDIN-COTTRELL INC	\$2,627.84	\$2,954.55	\$403.88
43-3N-28-509F-0005-0000	CHRIS & DEAN V BLAKE	\$2,627.84	\$2,954.55	\$403.88
43-3N-28-509F-0006-0000	DAVID L TURNER	\$2,627.84	\$2,954.55	\$403.88
43-3N-28-509F-0007-0000	DAVID L TURNER	\$2,627.84	\$2,954.55	\$403.88
43-3N-28-509F-0008-0000	KELLEY KIDD	\$2,627.84	\$2,954.55	\$403.88



<b>Parcel ID</b>	<b>Owner Name</b>	<b>Initial Prepayment</b>	<b>Adjusted Prepayment</b>	<b>Annual Assessment</b>
43-3N-28-509F-0009-0000	GLYNWOOD & NELL S HORNE	\$2,627.84	\$2,954.55	\$403.88
43-3N-28-509F-0010-0000	ABELARDO & CONCEPCION MONDERO	\$2,627.84	\$2,954.55	\$403.88
43-3N-28-509F-0011-0000	DAMON E & MADEA M GORDON	\$2,627.84	\$2,954.55	\$403.88
43-3N-28-509F-0012-0000	DAMON E & MADEA M GORDON	\$2,627.84	\$2,954.55	\$403.88
43-3N-28-509F-0013-0000	KEVIN T & DANNA E MINER CRUMP	\$2,627.84	\$2,954.55	\$403.88
43-3N-28-509F-0014-0000	CHARLES R & RUBY L MEREDITH	\$2,627.84	\$2,954.55	\$403.88
43-3N-28-509F-0015-0000	PAUL C JR & EATHA MAE WILSON	\$2,627.84	\$2,954.55	\$403.88
43-3N-28-509F-0016-0000	ARTURO T & AURELIA MATABAN	\$2,627.84	\$2,954.55	\$403.88
43-3N-28-509F-0017-0000	HOMER L & CHARLOTTE P HUTTO	\$2,627.84	\$2,954.55	\$403.88
43-3N-28-509F-0018-0000	DAVID L TURNER	\$2,627.84	\$2,954.55	\$403.88
43-3N-28-509F-0019-0000	MAULDIN-COTTRELL INC	\$2,627.84	\$2,954.55	\$403.88
43-3N-28-509F-0020-0000	MAULDIN-COTTRELL INC	\$2,627.84	\$2,954.55	\$403.88
43-3N-28-509F-0021-0000	MAULDIN-COTTRELL INC	\$2,627.84	\$2,954.55	\$403.88
43-3N-28-509F-0022-0000	BERTHA L & EUGENE HUNTSINGER	\$2,627.84	\$2,954.55	\$403.88
43-3N-28-509F-0023-0000	DANIEL O & PATRICIA A RYALS	\$2,627.84	\$2,954.55	\$403.88
43-3N-28-509G-0001-0000	JAMES K CROFT	\$2,627.84	\$2,954.55	\$403.88
43-3N-28-509G-0002-0000	JAMES K CROFT	\$2,627.84	\$2,954.55	\$403.88
43-3N-28-509G-0003-0000	JAMES K CROFT	\$2,627.84	\$2,954.55	\$403.88
43-3N-28-509G-0004-0000	JAMES K CROFT	\$2,627.84	\$2,954.55	\$403.88
43-3N-28-509G-0005-0000	KERRY S WOODS	\$2,627.84	\$2,954.55	\$403.88
43-3N-28-509G-0006-0000	MARY K & KENNETH SNYDER	\$2,627.84	\$2,954.55	\$403.88
43-3N-28-509G-0007-0000	LORIN G COPPOCK	\$2,627.84	\$2,954.55	\$403.88
43-3N-28-509G-0008-0000	MARION E HAFTEL	\$2,627.84	\$2,954.55	\$403.88
43-3N-28-509G-0009-0000	WILLIAM L & LINDA R CRAVEY	\$2,627.84	\$2,954.55	\$403.88
<b>Total Parcels: 334</b>		<b>\$924,999.85</b>	<b>\$1,040,001.76</b>	<b>\$142,165.58</b>

**APPENDIX F**

**FORM OF CERTIFICATE TO NON-AD VALOREM ASSESSMENT ROLL**

**CERTIFICATE**

**TO NON-AD VALOREM ASSESSMENT ROLL**

**I HEREBY CERTIFY** that, I am the Chairman of the Board of County Commissioners of Nassau County, Florida (the "County"); as such I have satisfied myself that all property included or includable on the non-ad valorem assessment roll for the Pirates Wood Assessment Area (the "Non-Ad Valorem Assessment Roll") for the County is properly assessed so far as I have been able to ascertain; and that all required extensions on the above-described roll to show the non-ad valorem assessments attributable to the property listed therein have been made pursuant to law.

**IFURTHER CERTIFY** that, in accordance with the Uniform Assessment Collection Act, this certificate and the herein described Non-Ad Valorem Assessment Roll will be delivered to the Nassau County Tax Collector by September 15, 20\_\_.

**IN WITNESS WHEREOF**, I have subscribed this certificate and directed the same to be delivered to the Nassau County Tax Collector and made part of the above described Non-Ad Valorem Assessment Roll this \_\_\_\_\_ day of \_\_\_\_\_, 20\_\_.

**BOARD OF COUNTY COMMISSIONERS  
OF NASSAU COUNTY, FLORIDA**

By: \_\_\_\_\_  
\_\_\_\_\_, Chairman

**[to be delivered each fiscal year to Tax Collector prior to September 15]**